

AL000024

Accessories • Fiber optics - add-on lenses

accessories fiber optic, Optic top part, zoom lens, diffuse-reflection sensor, M4x0.7 27long, für Diffuse reflection sensor, Internal thread, Aluminum+Glass



Mechanical features

Design	Internal thread
Diameter	8 mm
Housing coating	Anodized
Thread pitch	0.7 mm
Length	27.1 mm
Active area material of sensor	glass
Housing material	Aluminum
Thread dimension	M4

Other features

Suitable for	Diffuse reflection sensor
Version	Zoom lens

Classification

ETIM 8	EC002609 Accessories/spare parts for fiber optic technology
--------	-------------------------------------------------------------

More

IPF Product Group	900 accessories
packaging dimensions	165 x 100 x 15 mm
gross weight	10 g
Customs tariff number	90029000
WEEE number	40951076
OzDS-compliant	Yes
POP-compliant	Yes
Reach-compliant	Yes
RoHS-compliant	Yes

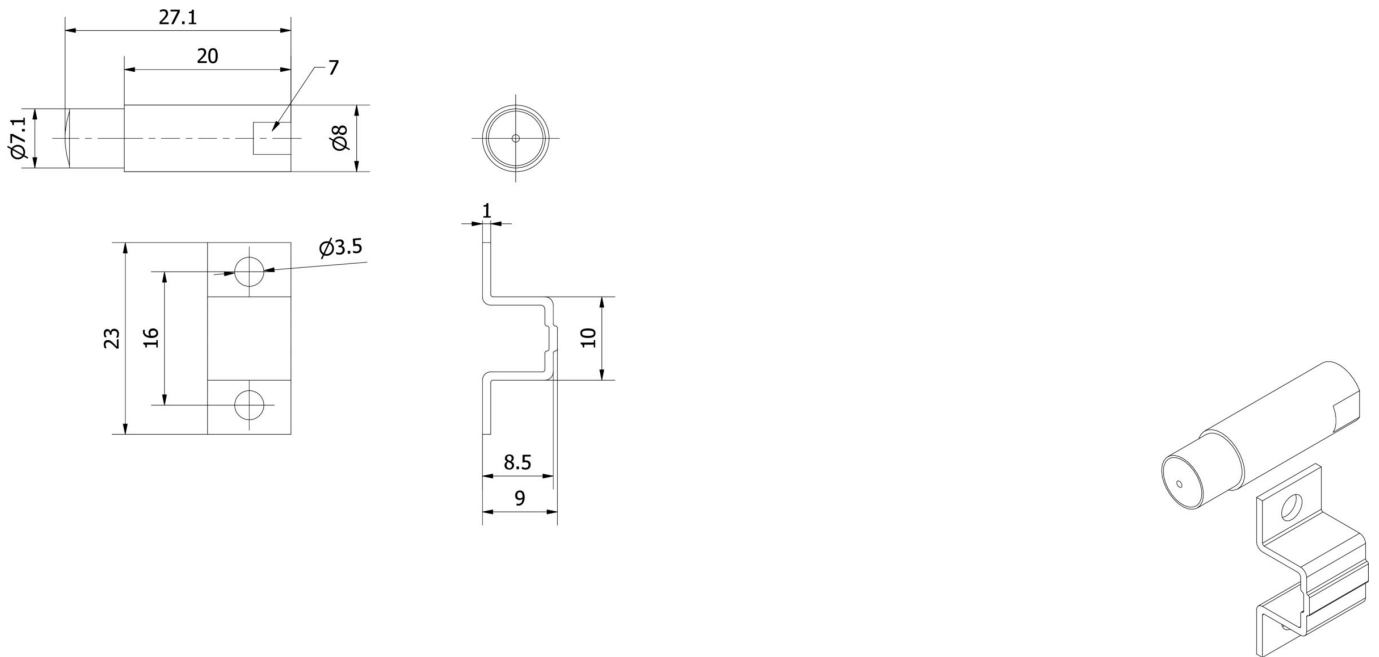
Dimensional drawing**Installation**

Mounting / installation may only be carried out by a qualified electrician!

**Disposal**

WEEE number according to § 6 para. 3
ElektroG: 40951076

Safety warnings

- / Before initial operation, please make sure to follow all safety instructions that may be provided in the product information.
- / Never use these devices in applications where the safety of a person depends on their functionality.