

AO000410

ACCESSORIES • LENSES

accessories optical, Lens Entocentric, Ø30mm 32long, F1.4/25mm, Minimum distance 250mm, C-mount (1-32 UN 2A), filter thread M27x0.5, Up to 2 megapixel, Focal distance Fixed



MECHANICAL FEATURES

Ambient temperature	-20 °C ... 50 °C
Filter thread size, metric	27
Lens connection	C-mount (1-32 UN 2A)
Lens diameter	29.5
Lens length	32 mm
Pitch of filter thread	0.5 mm
With C-mount thread	+

ELECTRICAL FEATURES

Aperture range	25 ... 25
----------------	-----------

OPTICAL FEATURES

Focal distance	Fixed
Focal distance range	25 mm ... 25 mm
Motor zoom	-
Minimum distance	250 mm
M.O.D	0.25
Aperture number	1.4
Lens type	Entocentric
Resolution capacity	Up to 2 megapixel

OTHER FEATURES

	Mechanical
Aperture control	Manual
Type of accessory	Lens

Other

Packaging dimensions	43.0mm x 43.0mm x 105.0mm
Shipping weight	0.08kg
Tariff code	90021100

Classification

ipf product group	914
eClass 8.0	27279205
eClass 9.0	27273603
eClass 9.1	27273603
ETIM-5.0	EC001776
ETIM-6.0	EC001776
ETIM-7.0	EC001776

Connection

Dimensional drawing

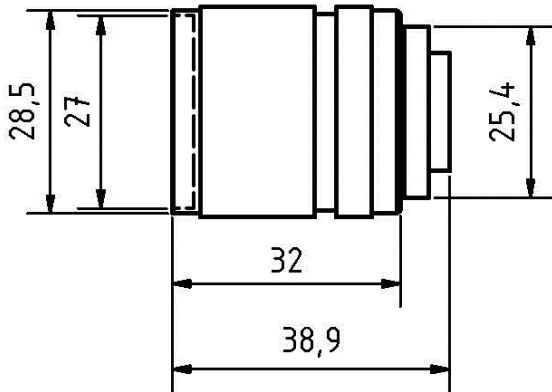

Installation



Mounting / installation may only be carried out by a qualified electrician!

Disposal



Safety warnings

Before initial operation, please make sure to follow all safety instructions that may be provided in the product information.

Never use these devices in applications where the safety of a person depends on their functionality.

LED lighting systems can generate intensive UV radiation, which can damage your eyes in case of improper use. The manufacturer cannot be held responsible for damages that result from improper use or connection.