

# AO000462

## Accessories • Flash controller

Flash controller, 55x120x130mm, 4 channels, 12-24V diagnostic coverage, terminals 6-pole, aluminum, LED

including Pin, SUB-D connector, Resistor



### Electrical features

Number of channels	4
Display	LED display
Type of electrical connection	Clamped terminal connection
Rated switching current	1000 mA
No-load current	5000 mA
Power consumption	120 VA
Number of pins	6
Switching voltage	30 V
Supported communication interface	Ethernet
Operating voltage (DC)	12 - 24 V

### Mechanical features

Design	Cuboid
Width	130 mm
Height	55.1 mm
Length	120 mm
Mounting method	Floor fastening
Housing material	Aluminum
Ambient temperature	-5 - 50 °C

### Other features

Version	Field device
---------	--------------

### Classification

ETIM 8	EC001485 Isolation amplifier
--------	------------------------------

**More**

IPF Product Group	915 camera illumination
packaging dimensions	160 x 140 x 80 mm
gross weight	790 g
Customs tariff number	85423190
WEEE number	40951076
Reach-compliant	Yes
RoHS-compliant	Yes

**Dimensional drawing**

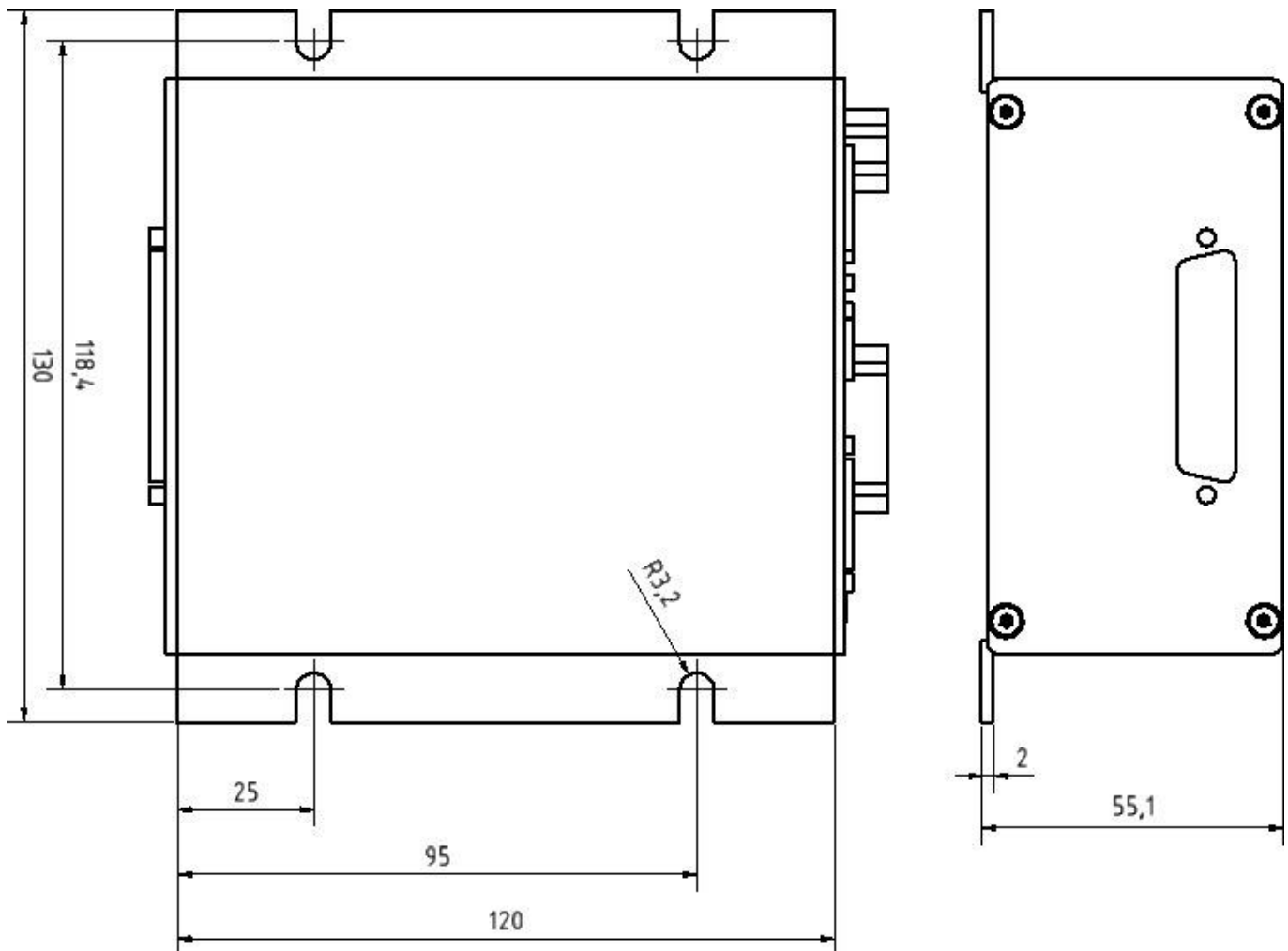

**Extract accessories program**

**AO000462**



Flash controller, 55x120x130mm,  
4 channels, 12-24V diagnostic  
coverage, terminals 6-pole,  
aluminum, LED

You can find further accessories on our homepage

---

**Installation**

Mounting / installation may only be carried out by a qualified electrician!

**Disposal**

---

**Safety warnings**

**/** Before initial operation, please make sure to follow all safety instructions that may be provided in the product information.

**/** Never use these devices in applications where the safety of a person depends on their functionality.

**/** Any software, drivers or IODD files that may be required to operate your device can be downloaded free of charge from our homepage: [www.ipf-electronic.com](http://www.ipf-electronic.com)