

AO000486

LED lights • Signal lights

LED signal light, M12x1 47long, multicolor LED, 0.9W, 10-30V DC, M12-connector 4-pin, IP67, stainl. steel+plastic diffuse

including Nut



Compact design VA housing

Signal lights, also described as indicator lights, are visual indicators that convey information via the status of devices or systems. They can signal certain messages or warnings using different colors and patterns such as flashing or lighting up. A high degree of protection and stainless steel housing ensure safe signal transducers.

Electrical features

Type of electrical connection	Connector M12
Rated operating current	16 mA
Power	0.9 W
Number of pins	4
Protection class	III
Reverse polarity protection	Yes
Operating voltage (DC)	10 - 30 V
Signal color	Green Red
ardSOCA_ElektrischerAnschluss	M12 4-pin plug connector
ardSOCA_Betriebsspannung	10-30VDC

Mechanical features

Design	Cylinder, screw-thread
Diameter	12 mm
Thread pitch	1 mm
Length	47 mm
Degree of protection (IP)	IP67
Front screen scattering behavior	diffuse
Housing material	Stainless steel 1.4305
Front screen material	Plastic
Thread dimension	M12
Ambient temperature	-20 - 50 °C
ardSOCA_Abmessungen	M12x1, 47mm long

Optical features

Number of LEDs	1
Illumination in the center (distance 1 m)	0.6 lx
Light source	Multi-colored LED
Angle of beam spread	170 °
Signal color	Green Red
Risk group	1

Other features

Harsh environmental conditions	Yes
--------------------------------	-----

Classification

ETIM 8	EC000348 Machine and workbench light
--------	--------------------------------------

More

IPF Product Group	190 machine illuminations
packaging dimensions	123 x 77 x 25 mm
gross weight	36 g
Customs tariff number	94054239
WEEE number	40951076
Reach-compliant	Yes
RoHS-compliant	Yes

Connection

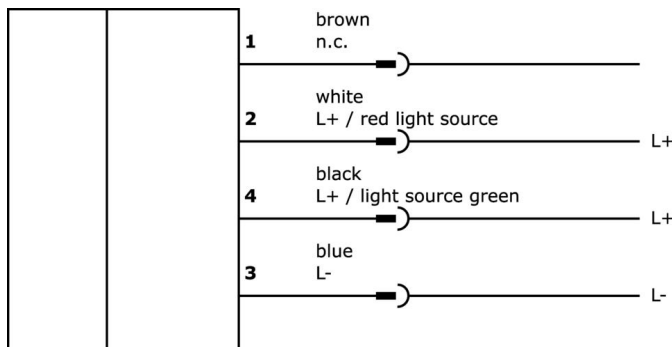

Dimensional drawing

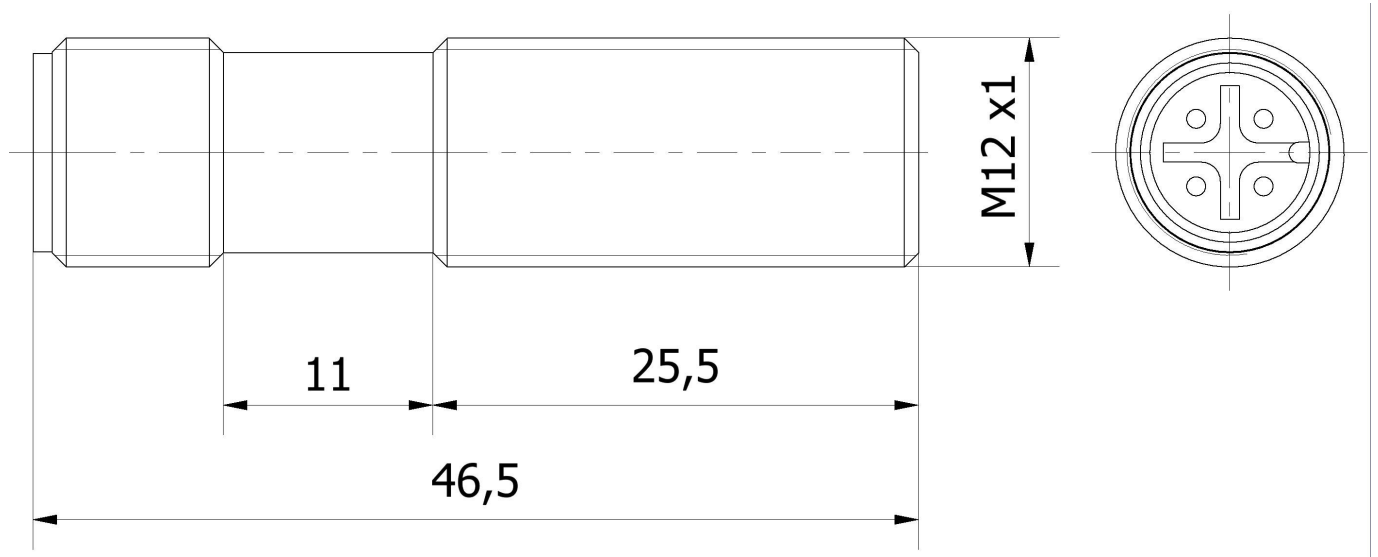

Extract accessories program

AY000025



accessories, Hexagon nut, M12x1, Wrench size 17mm, Brass Nickel-plated

AY000032



accessories sensor, Ø12mm, Aluminum, For sensor 12mm, for Wall mounting, Screw mounting

NG400501



DC power supply, 1-phase, 125x114x40mm, 24-28V, 5A, 90-264V AC 50Hz, 90-264V AC 60Hz, 127-370V DC, screw connection, IP20, aluminum, stabilized, pulsed output voltage

VK000041



Adaption, M12 Female (socket) 4pin Straight, M8 Male (connector) 4pin Straight, 24V, -25-85°C, IP67, Oil and cooling lubricants, Welding area

AY000159



accessories sensor, Mounting pipe, Ø12mm 200long, Aluminum Anodised

VK200321



Connection cable, 2m, M12 Female (socket) 4pin Angular, Free conductor end, 4x0.34mm², PUR (Polyurethane), Ø4.7mm, 250V, -40-90°C, IP67, Suitable for trailing chain and torsion resistant, Oil and cooling lubricants, Welding area, Silicone-free

VK200325



Connection cable, 2m, M12 Female (socket) 4pin Straight, Free conductor end, 4x0.34mm², PUR (Polyurethane), Ø4.7mm, 250V, -40-90°C, IP67, Suitable for trailing chain and torsion resistant, Oil and cooling lubricants, Welding area, Silicone-free

VK003020



Cable socket, angular, self-assembly, screw connection, Ø3-6. 5mm, 4A, 240V, -25-90°C, M12 socket 4-pin, IP67, PBT

VK003024



Cable socket, Straight, Suitable for self-assembly, Screw connection, Ø3-6.5mm, 4A, 240V, -25-90°C, M12 Female (socket) 4pin, IP67, PBT

You can find further accessories on our homepage



Installation

Mounting / installation may only be carried out by a qualified electrician!



Disposal

WEEE number according to § 6 para. 3 ElektroG: 40951076

Safety warnings

- /** Before initial operation, please make sure to follow all safety instructions that may be provided in the product information.
- /** Never use these devices in applications where the safety of a person depends on their functionality.
- /** LED lighting systems can generate intensive UV radiation, which can damage your eyes in case of improper use. The manufacturer cannot be held responsible for damages that result from improper use or connection.