

AV000021

Connection technology • Cable sockets / connectors for self-assembly

accessories rotary encoder, Cable socket, Straight, Suitable for self-assembly, Soldering connection, Ø5.8-6.2mm, 30A, -40-105°C, M23 Female (socket) 12pin



ipf cable sockets are used primarily for establishing the electrical connection of sensors. Their features are characterized by rugged design, the highest protection classes (IP67 | IP68 | IP69K) and, if desired, with 360° shielding. With the features: bus-ready, suitable for use with drag chains and robots, resistance to oil and chemicals, resistance to welding sparks, their resistance to cleaning agents or high-pressure and steam-jet cleaning, the expanded temperature range of up to +230°C, the rapid interconnection technology and special data transmission properties, the cable sockets meet all requirements in automation technology.

Electrical features

Type of plug-in contact, A connection	Female (socket)
Type of A electrical connection	M23
Type of B electrical connection	Soldering connection
Number of pins of A connection	12
Ampacity	30 A

Mechanical features

Wire cross section	1 mm ²
Cable infeed	straight
Cable infeed of A connection	straight
Permitted cable diameter	5,8 - 6,2 mm
Ambient temperature	-40 - 105 °C

Classification

ETIM 8	EC002635 Circular connector, field-wireable (industrial connector)
--------	--

More

IPF Product Group	900 accessories
packaging dimensions	120 x 100 x 26 mm
gross weight	80 g
Customs tariff number	85369010
WEEE number	40951076
OzDS-compliant	Yes
POP-compliant	Yes
Reach-compliant	Yes
RoHS-compliant	Yes

Connection

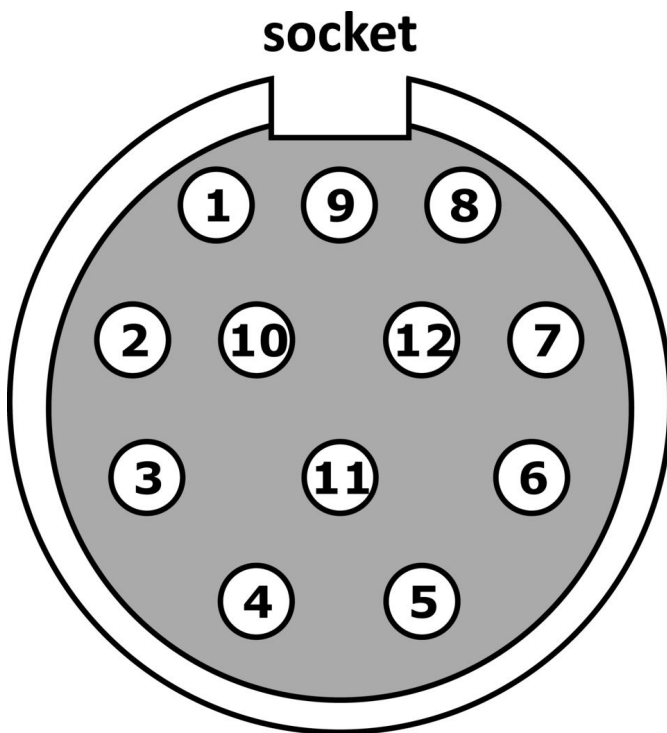

Dimensional drawing

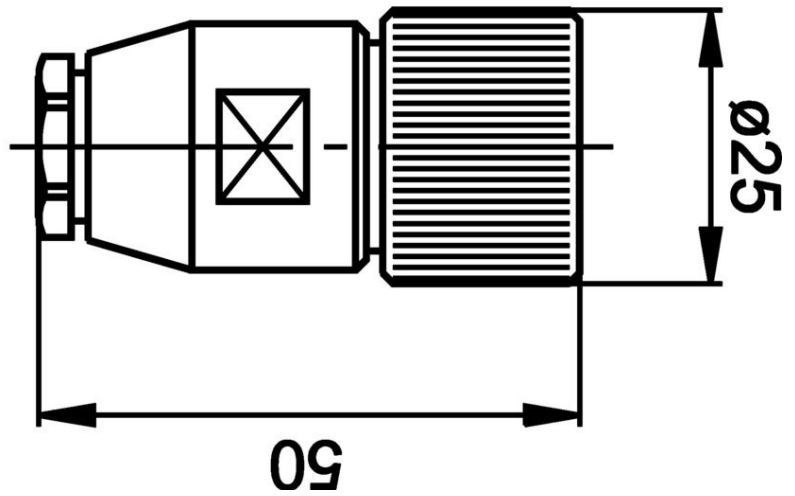
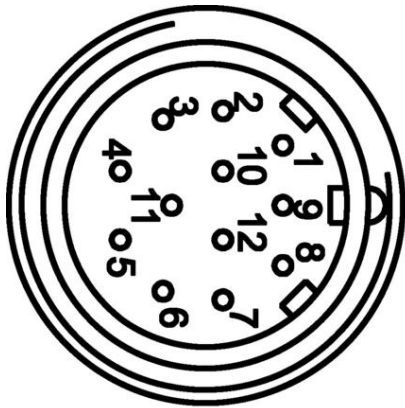

Installation

Mounting / installation may only be carried out by a qualified electrician!



Disposal

WEEE number according to § 6 para. 3
ElektroG: 40951076

Safety warnings

/ Before initial operation, please make sure to follow all safety instructions that may be provided in the product information.

/ Never use these devices in applications where the safety of a person depends on their functionality.