

CM030980

Counter • Multi-function counters

counter multifunctional, 48x108x48mm, Display LCD, 12 decades, 55kHz, 2x preset, 10-30V DC, 2x Relay contact Change-over contact (NO/NC), Screw connection 13pin, IP65, Plastic PC, Adding, Subtracting, Background lighting of LC display, With reset ...



Electrical features

Number of decades	12
Number of presets to be set	2
Number of switching outputs	2
Display	LCD display (illuminated)
Type of 2nd switching function	Change-over contact (NO/NC)
Type of switching function	Change-over contact (NO/NC)
Type of 2nd switching output	Relay contact
Type of electrical connection	Clamped terminal connection
Type of switching output	Relay contact
Type of signal input A	PNP/NPN
Type of signal input B	PNP/NPN
Rated switching current	3000 mA
Transducer power supply voltage	24 V
Transducer power supply current	80 mA
Power consumption	4.5 VA
Number of pins	13
Switching capacity	30 VA
Switching voltage	250 V
Timed output	0,01 - 99,99 s
Counting frequency	55 kHz
Operating voltage (DC)	10 - 30 V
With quadruple evaluation	Yes
With reset function	Yes
With elapsed-time counting function	Yes

Mechanical features

Width	48 mm
Installation depth	101 mm
Height	48 mm
Storage temperature	-25 - 75 °C
Length	108 mm
Mounting method	Panel mounting
Degree of protection (IP)	IP65
Housing material	Plastic PC
Ambient temperature	-20 - 65 °C

Other features

Relative air humidity (non-condensing)	93 %
counting functions	adding subtracting

Classification

ETIM 8	EC002300 Built-in pulse counter
--------	---------------------------------

More

IPF Product Group	500 counters
packaging dimensions	210 x 138 x 95 mm
gross weight	196 g
Customs tariff number	90291000
WEEE number	40951076
OzDS-compliant	Yes
POP-compliant	Yes
Reach-compliant	Yes
RoHS-compliant	Yes

Connection

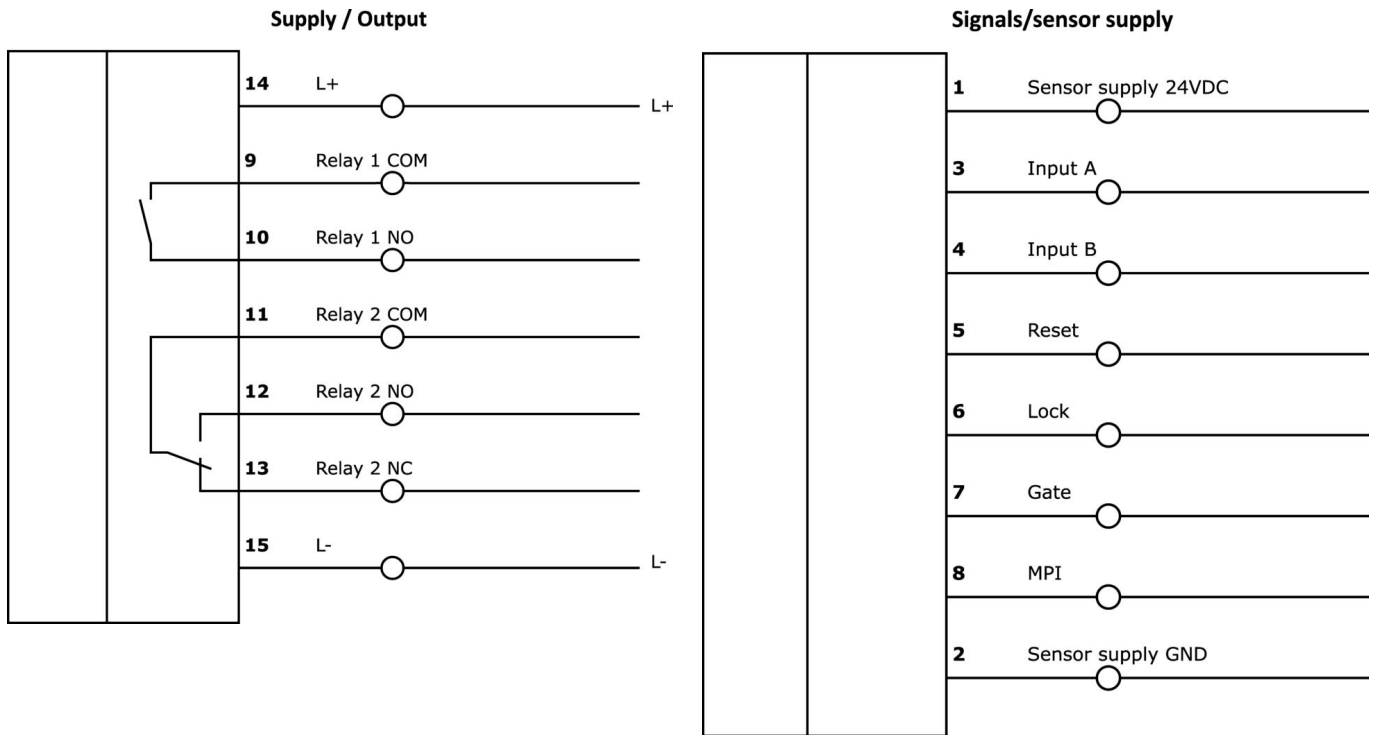

Dimensional drawing

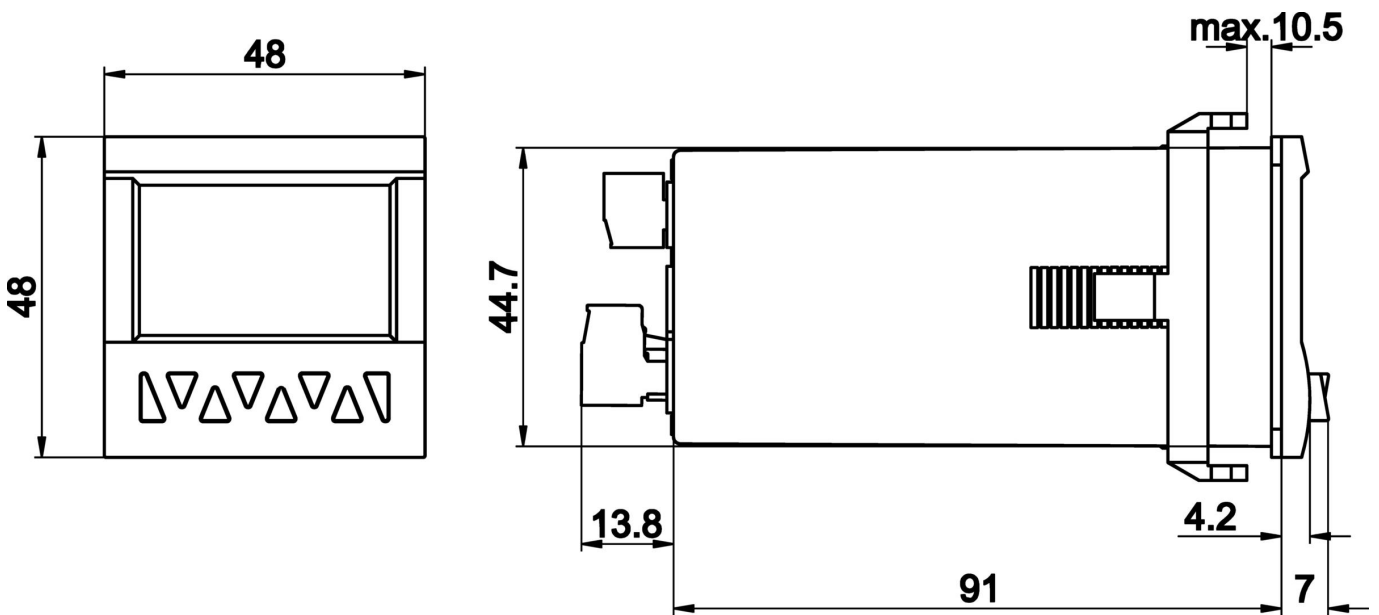

Extract accessories program**AC000037**

accessories counter, Mounting
frame, 72x72mm

AC000028

accessories counter, Mounting
frame, 60x75mm, Mounting type
Screwing

AC000036

accessories counter, Mounting rail
adapter, 145x84x70mm, Straight,
DIN rail (top hat rail) 35 mm,
Plastic, Snap connection

You can find further accessories on our homepage

**Installation**

Mounting / installation may only be carried
out by a qualified electrician!

**Disposal**

WEEE number according to § 6 para. 3
ElektroG: 40951076

Safety warnings

- / Before initial operation, please make sure to follow all safety instructions that may be provided in the product information.
- / Never use these devices in applications where the safety of a person depends on their functionality.