

ED870770

camera additional lighting • Transmitted light luminaire

LED transmitted light, 87x87x21mm, red light unpolarized, 3.6W, 635nm, 24V, M8 connector 4-pin, IP67, aluminum+PMMA



Homogeneous light guide

This homogeneous transmitted light illumination with an illuminated area of 87 x 87 mm is ideal for testing and measuring outlines. The lateral coupling of the LED light ensures very homogeneous illumination of the surface, which increases the quality of the inspection result. The transmitted light illumination is characterized by its very compact format with a housing height of only 21 mm.

Electrical features

Type of electrical connection	Connector M8
Rated operating current	150 mA
Flash controller	No
Power	3.6 W
Number of pins	4
Protection class	III
Operating voltage (DC)	24 V

Mechanical features

Design	square
Width	87 mm
Light field width	70 mm
Height	21 mm
Length	87 mm
Light field length	70 mm
Degree of protection (IP)	IP67
Front screen scattering behavior	diffuse
Housing material	Aluminum
Front screen material	Polymethyl methacrylate
Ambient temperature	10 - 50 °C

Optical features

Number of LEDs	64
Lamp	LED
Light source	Polarity free red light
Wavelength of the sensor	635 nm
Angle of beam spread	120 °
Risk group	0

Other features

Operational mode	Permanent operation Switching operation
------------------	---

Classification

ETIM 8	EC000348 Machine and workbench light
--------	--------------------------------------

More

IPF Product Group	915 camera illumination
packaging dimensions	175 x 135 x 65 mm
gross weight	250 g
Customs tariff number	94054239
WEEE number	40951076
Reach-compliant	Yes
RoHS-compliant	Yes

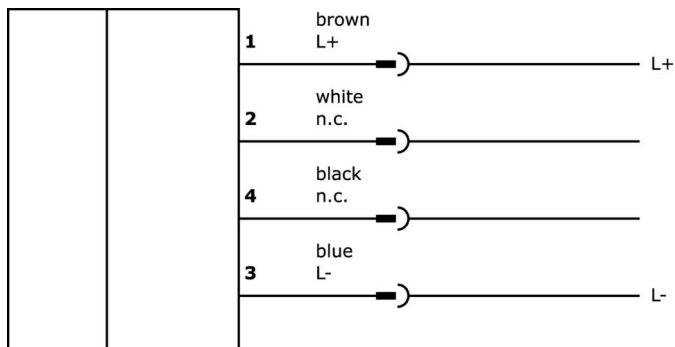
Connection

Dimensional drawing

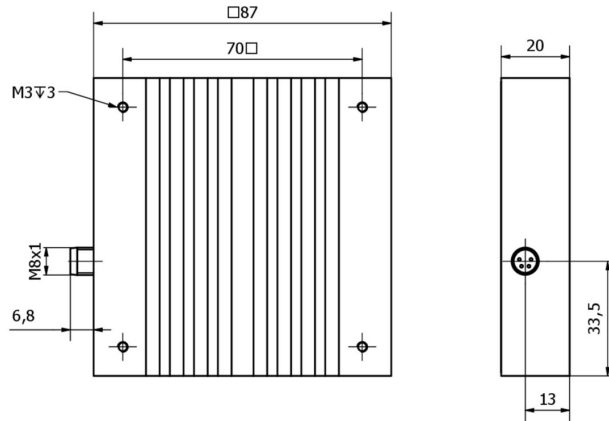

Extract accessories program

AO000462



Flash controller, 55x120x130mm, 4 channels, 12-24V diagnostic coverage, terminals 6-pole, aluminum, LED

VK000039



Adaption, M8 Female (socket) 4pin Straight, M8 Male (connector) 3pin Straight, 24V, -25-85°C, IP67, Oil and cooling lubricants, Welding area

VK000040



Adaption, M8 Female (socket) 4pin Straight, M12 Male (connector) 4pin Straight, 24V, -25-85°C, IP67, Oil and cooling lubricants, Welding area

VK200371



Connection cable, 2m, M8 Female (socket) 4pin Angular, Free conductor end, 4x0.34mm², PUR (Polyurethane), Ø4.7mm, 30V, -30-90°C, IP67, Suitable for trailing chain and torsion resistant, Oil and cooling lubricants, Welding area, Silicone-free

VK200375



Connection cable, 2m, M8 Female (socket) 4pin Straight, Free conductor end, 4x0.34mm², PUR (Polyurethane), Ø4.7mm, 30V, -30-90°C, IP67, Suitable for trailing chain and torsion resistant, Oil and cooling lubricants, Welding area, Silicone-free

VK030F71



Connection cable, 0.3m, M8 socket 4-pin angular, M8 connector 4-pin straight, 4-core, PUR (polyurethane), suitable for trailing chain and torsion resistant, oils and cooling lubricants, welding area, silicone-free

VK030F75



Connection cable, 0.3m, M8 socket 4-pin straight, M8 connector 4-pin straight, 4-core, PUR (polyurethane), suitable for trailing chain and torsion-resistant, oils and cooling lubricants, welding area, silicone-free

You can find further accessories on our homepage



Installation

Mounting / installation may only be carried out by a qualified electrician!



Disposal

WEEE number according to § 6 para. 3 ElektroG: 40951076

Safety warnings

- /** Before initial operation, please make sure to follow all safety instructions that may be provided in the product information.
- /** Never use these devices in applications where the safety of a person depends on their functionality.
- /** LED lighting systems can generate intensive UV radiation, which can damage your eyes in case of improper use. The manufacturer cannot be held responsible for damages that result from improper use or connection.