

EF1C0170

camera additional lighting • Dark field lights

LED dark field light, 105x130x12mm, white light, 5W, 5600K, 10-35V DC, M12 connector 3-pin, IP67, aluminum+plastic



/ External trigger input

For highlighting surface defects, scratches or engravings
Light intensity adjustable

The illumination of the test objects is provided by the lateral light exit at very shallow brackets. This illumination, also described as dark field illumination, is ideal for inspecting object surfaces or edges, as the lateral illumination means that the light is only reflected back to the camera from angled surfaces, such as scratches or relief structures.

The housing of the horizontal ring lights is particularly compact and can therefore also be used optimally in space-critical inspections. Due to the compact housing and shadow-free illumination, horizontal ring lights are also often used for barcode reading applications.

Electrical features

| | |
|-------------------------------|---------------------|
| Type of electrical connection | Cable connector M12 |
| Rated operating current | 200 mA |
| Flash controller | No |
| Power | 5 W |
| Number of pins | 3 |
| Protection class | III |
| Reverse polarity protection | Yes |
| Operating voltage (DC) | 10 - 35 V |

Mechanical features

| | |
|----------------------------------|-----------|
| Width | 130 mm |
| Height | 12 mm |
| Inner diameter | 60 mm |
| Cable length | 0.3 m |
| Length | 105 mm |
| Degree of protection (IP) | IP67 |
| Front screen scattering behavior | clear |
| Housing material | Aluminum |
| Front screen material | Plastic |
| Working distance range | 0 - 20 mm |
| Ambient temperature | 0 - 40 °C |

Optical features

| | |
|----------------------|-------------|
| Color temperature | 5600 K |
| Lamp | LED |
| Light source | White light |
| Angle of beam spread | 60 ° |
| Risk group | 0 |

Other features

| | |
|------------------|---|
| Operational mode | Permanent operation Switching operation |
|------------------|---|

Classification

| | |
|--------|--------------------------------------|
| ETIM 8 | EC000348 Machine and workbench light |
|--------|--------------------------------------|

More

| | |
|-----------------------|-------------------------|
| IPF Product Group | 915 camera illumination |
| packaging dimensions | 210 x 138 x 95 mm |
| gross weight | 368 g |
| Customs tariff number | 94054239 |
| WEEE number | 40951076 |
| Reach-compliant | Yes |
| RoHS-compliant | Yes |

Connection

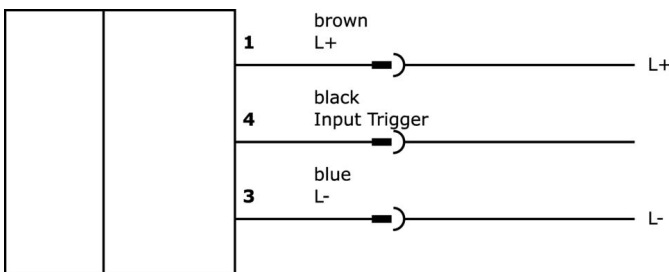

Dimensional drawing

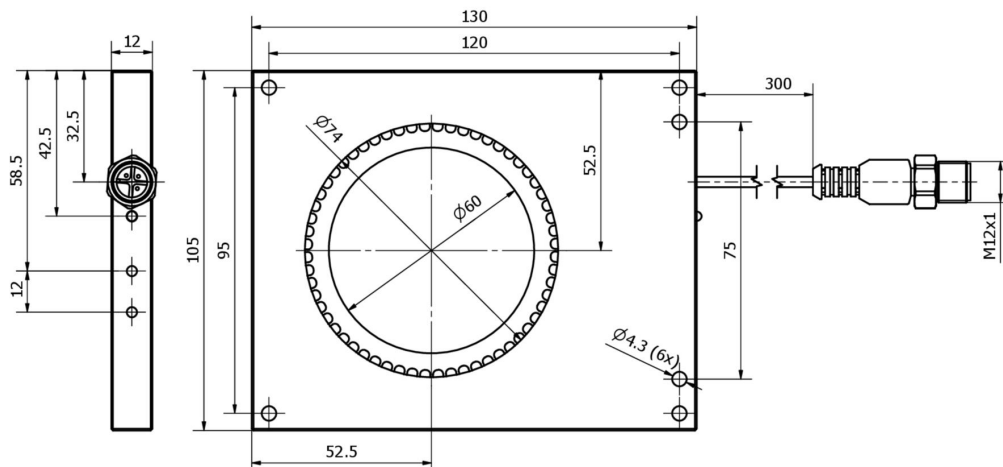

Extract accessories program

VK200021



Connection cable, 2m, M12
Female (socket) 3pin Angular, Free conductor end, 3x0.34mm², PUR (Polyurethane), Ø4.3mm, 250V, -30-90°C, IP67, Suitable for trailing chain and torsion resistant, Oil and cooling lubricants, Welding area, Silicone-free

VK200025



Connection cable, 2m, M12
Female (socket) 3pin Straight, Free conductor end, 3x0.34mm², PUR (Polyurethane), Ø4.3mm, 250V, -30-90°C, IP67, Suitable for trailing chain and torsion resistant, Oil and cooling lubricants, Welding area, Silicone-free

You can find further accessories on our homepage



Installation

Mounting / installation may only be carried out by a qualified electrician!



Disposal

WEEE number according to § 6 para. 3 ElektroG: 40951076

Safety warnings

/ Before initial operation, please make sure to follow all safety instructions that may be provided in the product information.

/ Never use these devices in applications where the safety of a person depends on their functionality.

/ LED lighting systems can generate intensive UV radiation, which can damage your eyes in case of improper use. The manufacturer cannot be held responsible for damages that result from improper use or connection.