

## ES160100

### camera additional lighting • Spotlights

LED spotlight, 16x58.8mm, white light, 2W, 6020K, 16mm optics, focusable, 24V DC, IP20



**Suitable for continuous and flash operation**  
**Light can be focused or homogeneously blurred via lens**

The minispots are particularly suitable for (partial) incident light applications with short operating distances. The light can be focused or unfocused via the lens. The minispot is available as standard in the versions ES160100 with a 6 mm lens and ES160101 with a 16 mm lens. The spots are compatible with standard S-mount lenses. The special holder is suitable for precisely aligning the spot and ensuring a good thermal connection.

#### Electrical features

Type of electrical connection	Cable
Rated operating current	600 mA
Flash controller	External in connection cable
Power	2 W
Max. peak current	1500 mA
Number of pins	4
Protection class	III
Operating voltage (DC)	22,8 - 25,2 V
ardSOCA_ElektrischerAnschluss	Cable tail 4-pole
ardSOCA_Betriebsspannung	23-25VDC

#### Mechanical features

Design	Pipe
Diameter	16 mm
Length	58.8 mm
Degree of protection (IP)	IP20
Housing material	Aluminum
Working distance range	10 - 500 mm
Ambient temperature	10 - 30 °C
ardSOCA_Abmessungen	Ø16mm, 58.8mm long

**Optical features**

Number of LEDs	1
Focal distance range	16 mm
Color temperature	6020 K
Lamp	LED
Light source	White light
Risk group	2

**Other features**

Relative air humidity (non-condensing)	30 - 70 %
Operational mode	Permanent operation   Switching operation   Flash operation

**Classification**

ETIM 8	EC000348 Machine and workbench light
--------	--------------------------------------

**More**

IPF Product Group	915 camera illumination
packaging dimensions	295 x 230 x 55 mm
gross weight	291 g
Customs tariff number	94054239
WEEE number	40951076
Reach-compliant	Yes
RoHS-compliant	Yes

**Important notes**

- /** This item generates heat, which has a direct impact on its service life. Temperature generation can be reduced by mounting on a heat conducting surface.
- /** Temperatura de superficie elevada superior a 55°C en funcionamiento continuo.
- /** Utilice el soporte original para disipar el calor

**Connection**

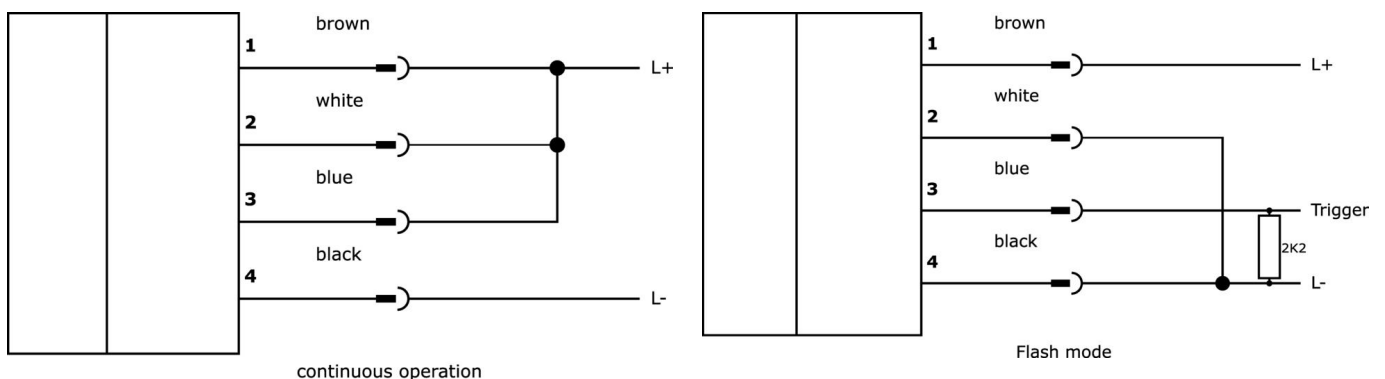

**Dimensional drawing**

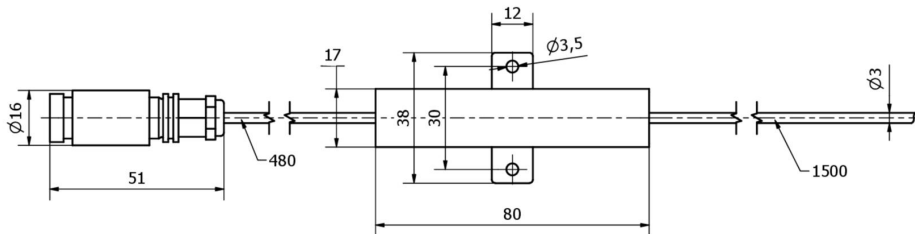

**Extract accessories program**

**AO000656**



Accessories Optical, mounting  
 bracket for Minispot ES16, 46x22,  
 5x14mm

You can find further accessories on our homepage



**Installation**

Mounting / installation may only be carried out by a qualified electrician!



**Disposal**

WEEE number according to § 6 para. 3  
 ElektroG: 40951076

**Safety warnings**

- / Before initial operation, please make sure to follow all safety instructions that may be provided in the product information.
- / Never use these devices in applications where the safety of a person depends on their functionality.
- / LED lighting systems can generate intensive UV radiation, which can damage your eyes in case of improper use. The manufacturer cannot be held responsible for damages that result from improper use or connection.