

ES460720

camera additional lighting • Spotlights

LED spotlight, 56x46x46mm, red light, 6W, 625nm, 13° angle of emitted beam, 24V DC, M12-connector 5-pin, IP54, aluminum+PMMA



small angle of emitted beam

The spotlights in the "EP460x20" series use particularly bright LEDs. These deliver approx. four times as much power as standard LEDs. In addition to the brighter LEDs, there is a small lens on each LED that focuses the light to a smaller angle of beam spread. This provides additional brightness even at greater distances. Another lens on the light exit in the housing ensures a defined angle of beam spread of 13°. The optional holder enables precise alignment to the desired operating range.

Electrical features

| | |
|-------------------------------|-----------------------------|
| Type of electrical connection | Connector M12 |
| Rated operating current | 600 mA |
| Flash controller | internal |
| Power | 6 W |
| Max. peak current | 1500 mA |
| Number of pins | 5 |
| Protection class | III |
| Operating voltage (DC) | 22,8 - 25,2 V |
| ardSOCA_ElektrischerAnschluss | M12 5-pin plug connector |
| ardSOCA_Betriebsspannung | 23-25VDC |
| ardTEEL_Schutzfunktionen | Reverse polarity protection |

Mechanical features

| | |
|----------------------------------|---------------|
| Width | 46 mm |
| Height | 56 mm |
| Length | 46 mm |
| Degree of protection (IP) | IP54 |
| Front screen scattering behavior | diffuse |
| Housing material | Aluminum |
| Front screen material | Polycarbonate |
| Working distance range | 100 - 700 mm |
| Ambient temperature | 10 - 30 °C |
| ardSOCA_Abmessungen | 46x46x56mm |

Optical features

| | |
|--------------------------|-------------------------|
| Number of LEDs | 1 |
| Lamp | LED |
| Light source | Polarity free red light |
| Wavelength of the sensor | 625 nm |
| Angle of beam spread | 13 ° |
| Risk group | 2 |

Other features

| | |
|--|---|
| Relative air humidity (non-condensing) | 30 - 70 % |
| Operational mode | Flash operation Permanent operation Switching operation |

Classification

| | |
|--------|--------------------------------------|
| ETIM 8 | EC000348 Machine and workbench light |
|--------|--------------------------------------|

More

| | |
|-----------------------|-------------------------|
| IPF Product Group | 915 camera illumination |
| packaging dimensions | |
| gross weight | |
| Customs tariff number | 94054239 |
| WEEE number | 40951076 |
| Reach-compliant | Yes |
| RoHS-compliant | Yes |

Connection

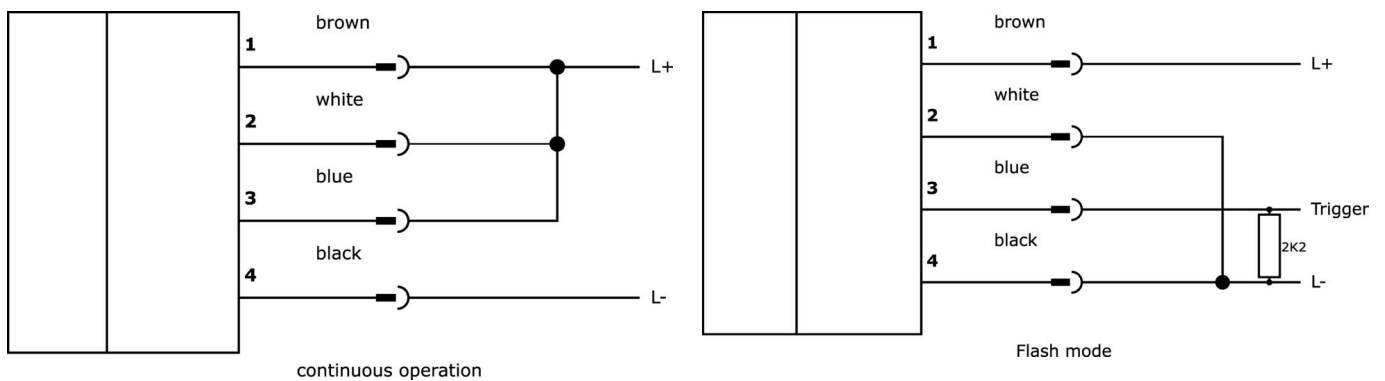

Dimensional drawing

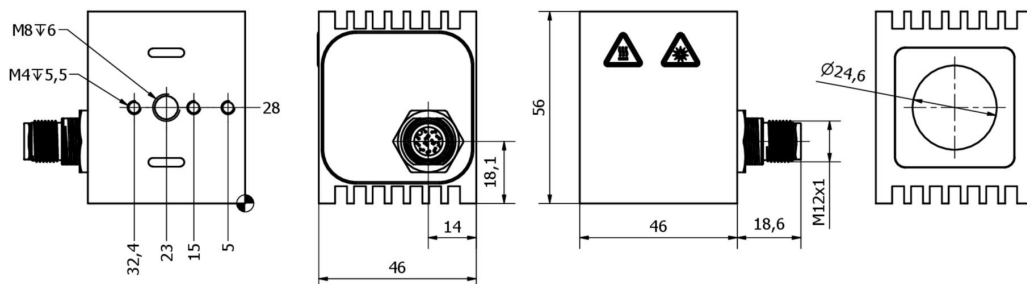

Extract accessories program

AO000660



Light up accessories, ball joint holder, 40x40x100mm, 360° rotatable, 180° swivel, white aluminum

AO000673



Accessories Optical, ball-and-socket joint, M8 threaded bolt, 40x55mm, aluminum

VK200321



Connection cable, 2m, M12 Female (socket) 4pin Angular, Free conductor end, 4x0.34mm², PUR (Polyurethane), ∅4.7mm, 250V, -40-90°C, IP67, Suitable for trailing chain and torsion resistant, Oil and cooling lubricants, Welding area, Silicone-free

VK200325



Connection cable, 2m, M12 Female (socket) 4pin Straight, Free conductor end, 4x0.34mm², PUR (Polyurethane), ∅4.7mm, 250V, -40-90°C, IP67, Suitable for trailing chain and torsion resistant, Oil and cooling lubricants, Welding area, Silicone-free

VK200621



Connection cable, 2m, M12 Female (socket) 5pin Angular, Free conductor end, 5x0.34mm², PUR (Polyurethane), ∅5.4mm, 60V, -25-90°C, IP67, Suitable for trailing chain and torsion resistant, Oil and cooling lubricants, Welding area, Silicone-free

VK200625



Connection cable, 2m, M12 Female (socket) 5pin Straight, Free conductor end, 5x0.34mm², PUR (Polyurethane), ∅5.4mm, 60V, -25-90°C, IP67, Suitable for trailing chain and torsion resistant, Oil and cooling lubricants, Welding area, Silicone-free

VK06F004



Line for camera lighting in flash mode on OC53 with internal flash controller, 0.6m, M8 connector 4-pin straight, M12 socket 4-pin straight, 4-wire

VK06F003



Line for camera lighting in continuous operation on OC53 with internal flash controller, 0.6m, M8 connector 4-pin straight, M12 socket 4-pin straight, 4-wire

You can find further accessories on our homepage



Installation

Mounting / installation may only be carried out by a qualified electrician!



Disposal

WEEE number according to § 6 para. 3 ElektroG: 40951076

Safety warnings

- /** Before initial operation, please make sure to follow all safety instructions that may be provided in the product information.
- /** Never use these devices in applications where the safety of a person depends on their functionality.
- /** LED lighting systems can generate intensive UV radiation, which can damage your eyes in case of improper use. The manufacturer cannot be held responsible for damages that result from improper use or connection.