

## IB090102

### Inductive sensors • Norm switching distance

sensor inductive, 40x8x8mm, Flush, Sn: 1.5, 10-30V DC, PNP NO, Cable 10m PVC, IP67, Brass Nickel-plated



The IB090102 inductive sensor is specially designed to detect conductive metals at short distances while remaining unaffected by other materials. This makes it ideal for use in soiling areas and harsh environmental conditions.

The sensor complies with EN 60947-5-2 and is suitable for standard applications. The switching distance is set at the factory using a norm measuring plate that has the same edge length as the sensor surface. In accordance with the standards, the flush-mounted sensor achieves a switching distance of 1.5 mm. The housing of the sensor is cuboid and made of brass with a cut-in thread. The sensor is electrically connected via a 3-wire 10 m connection cable.

#### Electrical features

Display	LED display
Type of switching function	Normally open contact (NO)
Type of electrical connection	Cable
Type of switching output	PNP
Rated switching current	200 mA
Relative hysteresis	5 %
Short-circuit protection	Yes
No-load current	10 mA
Switching distance	1,5 mm
Switching frequency	1000 Hz
Voltage drop	2 V
Reverse polarity protection	Yes
Operating voltage (DC)	10 - 30 V

**Mechanical features**

Number of cores	3
Design	Cuboid
Width	8 mm
Height	40 mm
Cable length	10 m
Cable infeed	axial
Length	8 mm
Maximum tightening torque	1 Nm
Mechanical mounting condition for sensor	flush
Surface	nickel-plated
Degree of protection (IP)	IP67
Active area material of sensor	Plastic (PA6.1, glass fiber reinforced 15%)
Housing material	Brass
Material of cable sheath	Plastic (PVC)
Ambient temperature	-25 - 70 °C

**Classification**

ETIM 8	EC002714 Inductive proximity switch
--------	-------------------------------------

**More**

IPF Product Group	215 inductive sensors (cuboid)
packaging dimensions	143 x 74 x 74 mm
gross weight	163 g
Customs tariff number	85365019
WEEE number	40951076
OzDS-compliant	Yes
POP-compliant	Yes
Reach-compliant	Yes
RoHS-compliant	Yes

**Connection**

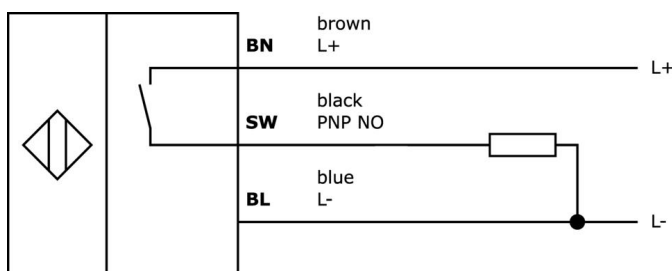

**Dimensional drawing**

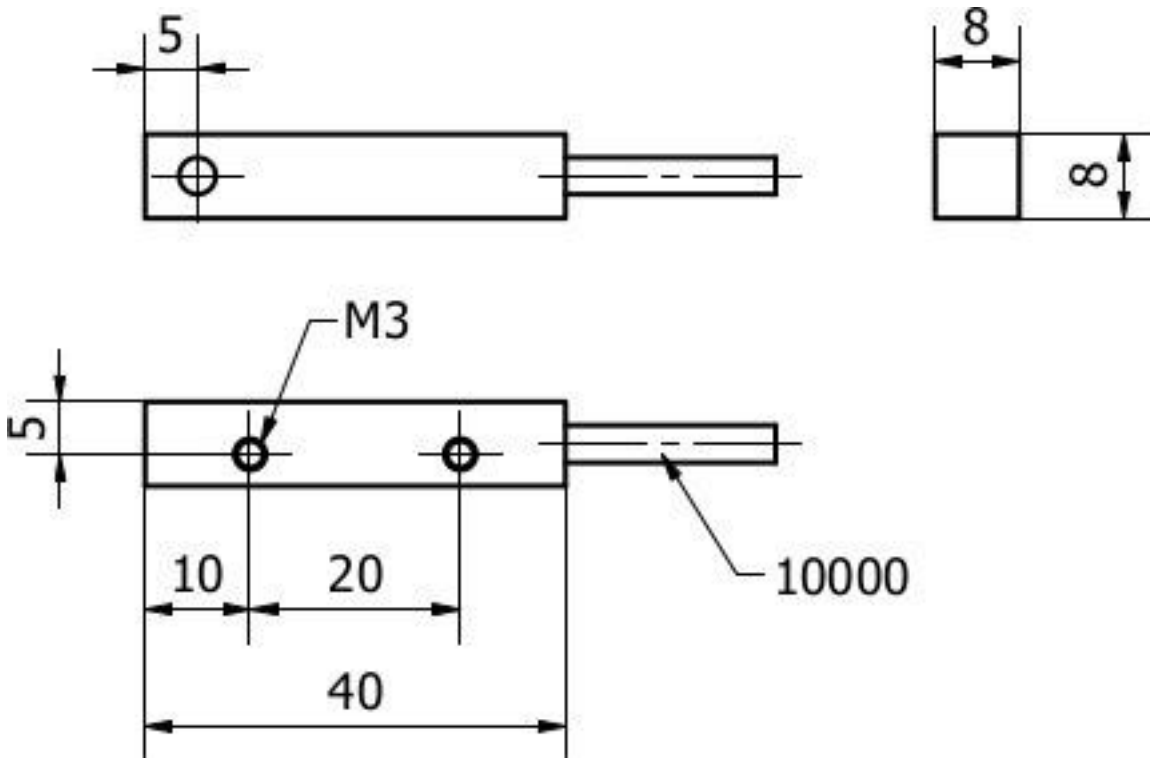

**Extract accessories program**

**NG400501**



DC power supply, 1-phase, 125x114x40mm, 24-28V, 5A, 90-264V AC 50Hz, 90-264V AC 60Hz, 127-370V DC, screw connection, IP20, aluminum, stabilized, pulsed output voltage

**VK003026**



Cable connector, Angular, Suitable for self-assembly, Screw connection, Ø3-6.5mm, 4A, 240V, -25-90°C, M12 Male (connector) 4pin, IP67, PBT

**VK003028**



Cable connector, Straight, Suitable for self-assembly, Screw connection, Ø3-6.5mm, 4A, 240V, -25-90°C, M12 Male (connector) 4pin, IP67, PBT

**VK003076**



Cable connector, Angular, Suitable for self-assembly, Soldering connection, 4A, 60V, -40-85°C, M8 Male (connector) 3pin, IP67, Brass

**VK003078**



Cable connector, Straight, Suitable for self-assembly, Soldering connection, Ø3.5-5mm, 4A, 60V, -40-85°C, M8 Male (connector) 3pin, IP67, Brass

**VK003079**



Cable connector, Straight, Suitable for self-assembly, Soldering connection, Ø3.5-5mm, 4A, 30V, -40-85°C, M8 Male (connector) 4pin, IP67, Brass

**VK003179**



Cable connector, Straight, Suitable for self-assembly, Screw connection, Ø3.5-5mm, 4A, 30V, -40-85°C, M8 Male (connector) 4pin, IP67, Brass

**AY000118**



accessories sensor, Fixture kit, Metal, ball joint

**AY000141**



Plastic sheath, Ø17mm, Inner diameter 10mm, -40-250°C, Glass fiber with silicone rubber, Short-term resistance to weld spatter 1200°C, Tensile strength 400N, Flexible, Flame retardant, yard good

You can find further accessories on our homepage

**Installation**

Mounting / installation may only be carried out by a qualified electrician!

**Disposal**

WEEE number according to § 6 para. 3  
ElektroG: 40951076

**Safety warnings**

- / Before initial operation, please make sure to follow all safety instructions that may be provided in the product information.
- / Never use these devices in applications where the safety of a person depends on their functionality.