

## IB130170

### Inductive sensors • Norm switching distance

Sensor inductive, 65x12x12mm, flush, Sn: 4, 10-30V DC, PNP NO, M8 plug connector 3-pin, IP67, chrome-plated brass



The IB130170 inductive sensor is particularly suitable for use in soiling and harsh environments, as it can detect conductive metals at short distances without being affected by other materials. This sensor complies with the EN 60947-5-2 standard and is suitable for standard applications. The switching distance of 4 mm is set at the factory using a norm measuring plate whose edge length corresponds to the diameter of the sensor surface. The sensor can be flush-mounted and its housing is made of brass with cut-in threads. The electrical connection is made via a 3-pin M8 plug connector.

#### Electrical features

|                               |                            |
|-------------------------------|----------------------------|
| Display                       | LED display                |
| Type of switching function    | Normally open contact (NO) |
| Type of electrical connection | Connector M8               |
| Type of switching output      | PNP                        |
| Rated switching current       | 200 mA                     |
| Relative hysteresis           | 10 %                       |
| Short-circuit protection      | Yes                        |
| No-load current               | 15 mA                      |
| Number of pins                | 3                          |
| Switching distance            | 4 mm                       |
| Switching frequency           | 800 Hz                     |
| Voltage drop                  | 2 V                        |
| Reverse polarity protection   | Yes                        |
| Operating voltage (DC)        | 10 - 30 V                  |

#### Mechanical features

|  |               |
|--|---------------|
| Design                                   | Cuboid        |
| Width                                    | 12 mm         |
| Height                                   | 65 mm         |
| Cable infeed                             | axial         |
| Length                                   | 12 mm         |
| Mechanical mounting condition for sensor | flush         |
| Surface                                  | Chrome-plated |
| Degree of protection (IP)                | IP67          |
| Active area material of sensor           | Plastic (PBT) |
| Housing material                         | Brass         |
| Ambient temperature                      | -25 - 70 °C   |

**Classification**

|        |                                     |
|--------|-------------------------------------|
| ETIM 8 | EC002714 Inductive proximity switch |
|--------|-------------------------------------|

**More**

|                       |                                |
|-----------------------|--------------------------------|
| IPF Product Group     | 215 inductive sensors (cuboid) |
| packaging dimensions  | 120 x 100 x 17 mm              |
| gross weight          | 40 g                           |
| Customs tariff number | 85365019                       |
| WEEE number           | 40951076                       |
| OzDS-compliant        | Yes                            |
| POP-compliant         | Yes                            |
| Reach-compliant       | Yes                            |
| RoHS-compliant        | Yes                            |

**Connection**

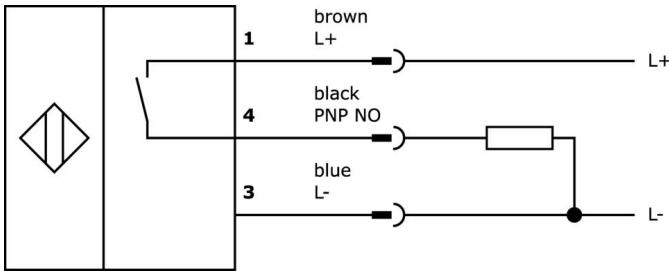

Dimensional drawing

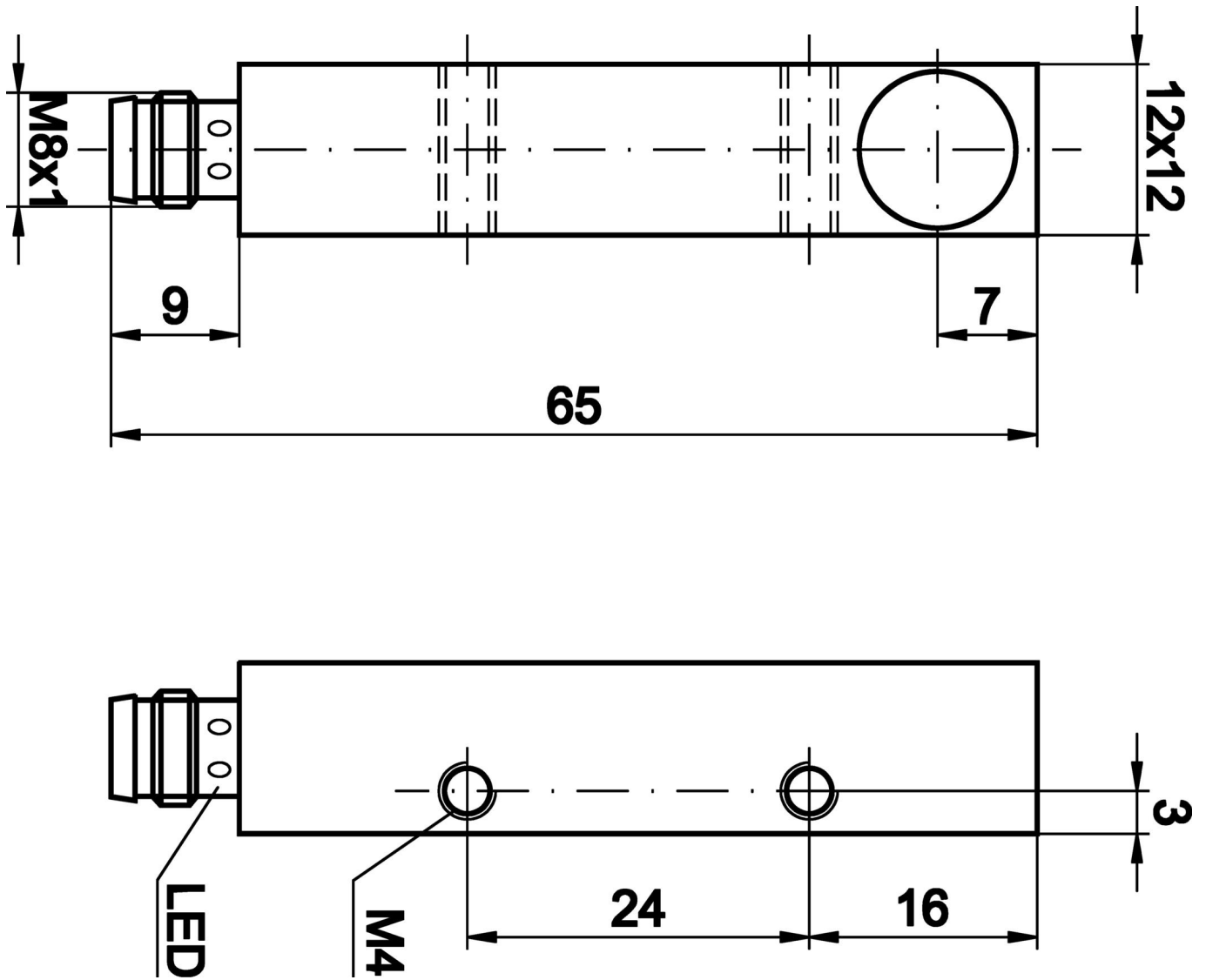

**Extract accessories program**

**AY000058**



accessories sensor, Mounting angle bracket, M4x0.7 12long, Mounting material for sensor, brackets, Aluminum

**AY000119**



accessories sensor, Fixture kit, Metal, ball joint

**VY000004**



DC power supply, sensor tester, 120x26x72mm, 18V, 0.04A, Spring clamp connection 4pin, IP20, Plastic

**AY98C293**



accessories sensor, Teflon cap, M8x1 5long, Polytetrafluorethylene (PTFE)

**VK003070**



Cable socket, Angular, Suitable for self-assembly, Soldering connection, Ø3.5-5mm, 4A, 60V, -40-85°C, M8 Female (socket) 3pin, IP67, Brass

**VK003074**



Cable socket, Straight, Suitable for self-assembly, Soldering connection, Ø3.5-5mm, 4A, 60V, -40-85°C, M8 Female (socket) 3pin, IP67, Brass

**VL300138**



Logic module, 26x136x30mm, OR, 2x4fold, 10-30V DC, sensor side M8 Female (socket) 3pin, control side M12 Male (connector) 12pin, IP67, Plastic

**VL300148**



Logic module, 26x136x30mm, AND, 4fold, 10-30V DC, sensor side M8 Female (socket) 3pin, control side M12 Male (connector) 12pin, IP67, Plastic, Signal change logic

**VY030170**



time stage, Turn-off delay, 0-0.15s, 10-35V DC, 1x NO, M8 3pin 0.3m, IP67, Plastic, Potentiometer

You can find further accessories on our homepage



**Installation**

Mounting / installation may only be carried out by a qualified electrician!



**Disposal**

WEEE number according to § 6 para. 3 ElektroG: 40951076

**Safety warnings**

- / Before initial operation, please make sure to follow all safety instructions that may be provided in the product information.
- / Never use these devices in applications where the safety of a person depends on their functionality.