

IB160105

Inductive sensors • Norm switching distance

sensor inductive, 28x10x16mm, Flush, Sn: 2, 10-30V DC, PNP NO, Cable 2m PVC, IP67, PA 6 (synthetic)



The IB160105 is an inductive sensor that can detect conductive metals at short distances and is not affected by other materials. This makes it ideal for use in soiling areas and harsh environmental conditions. The sensor is manufactured in accordance with EN 60947-5-2 and is suitable for standard applications. The switching distance of the sensor is set at the factory using a norm measuring plate whose edge length corresponds to the diameter of the sensor surface.

In accordance with the EN 60947-5-2 standard, the switching distance of the IB160105 flush-mounted sensor is 2 mm. The housing of the sensor is cuboid and made of plastic (PA 6) with an incised thread. The electrical connection is made via a 3-wire 2m connection cable.

Electrical features

Display	LED display
Type of switching function	Normally open contact (NO)
Type of electrical connection	Cable
Type of switching output	PNP
Rated switching current	200 mA
Relative hysteresis	15 %
Short-circuit protection	Yes
No-load current	13 mA
Switching distance	2 mm
Switching frequency	1000 Hz
Voltage drop	2.4 V
Reverse polarity protection	Yes
Operating voltage (DC)	10 - 30 V

Mechanical features

Number of cores	3
Design	Cuboid
Width	16 mm
Height	28 mm
Cable length	2 m
Cable infeed	axial
Length	10.4 mm
Mechanical mounting condition for sensor	flush
Degree of protection (IP)	IP67
Active area material of sensor	Plastic (PA6)
Housing material	PA 6 (synthetic)
Material of cable sheath	Plastic (PVC)
Ambient temperature	-25 - 70 °C

Classification

ETIM 8	EC002714 Inductive proximity switch
--------	-------------------------------------

More

IPF Product Group	215 inductive sensors (cuboid)
packaging dimensions	120 x 100 x 17 mm
gross weight	33 g
Customs tariff number	85365019
WEEE number	40951076
OzDS-compliant	Yes
POP-compliant	Yes
Reach-compliant	Yes
RoHS-compliant	Yes

Connection

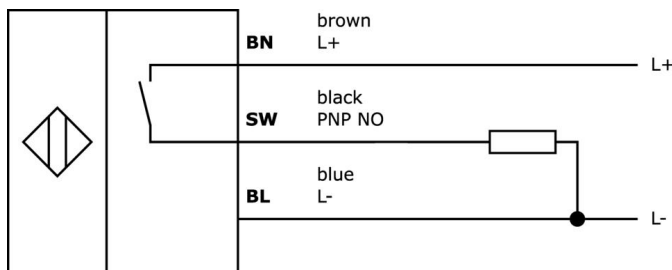

Dimensional drawing

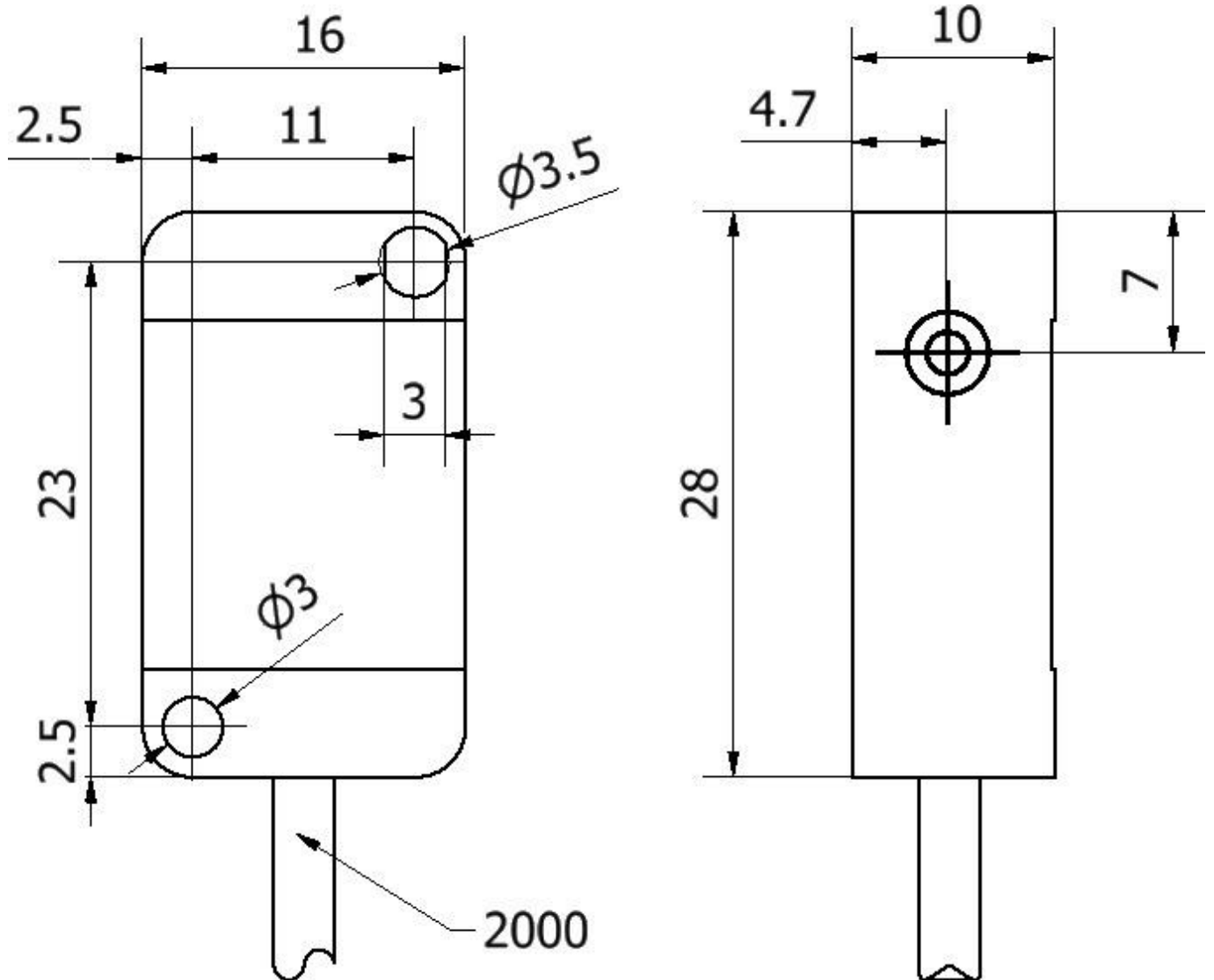

Extract accessories program

AY000141



Plastic sheath, Ø17mm, Inner diameter 10mm, -40-250°C, Glass fiber with silicone rubber, Short-term resistance to weld spatter 1200°C, Tensile strength 400N, Flexible, Flame retardant, yard good

AY000118



accessories sensor, Fixture kit, Metal, ball joint

AY000162



Accessories, magnetic, Ø43mm, neodymium-iron-boron, inside thread M5, rubber

VK003076



Cable connector, Angular, Suitable for self-assembly, Soldering connection, 4A, 60V, -40-85°C, M8 Male (connector) 3pin, IP67, Brass

VK003078



Cable connector, Straight, Suitable for self-assembly, Soldering connection, Ø3.5-5mm, 4A, 60V, -40-85°C, M8 Male (connector) 3pin, IP67, Brass

VK003079



Cable connector, Straight, Suitable for self-assembly, Soldering connection, Ø3.5-5mm, 4A, 30V, -40-85°C, M8 Male (connector) 4pin, IP67, Brass

VK003179



Cable connector, Straight, Suitable for self-assembly, Screw connection, Ø3.5-5mm, 4A, 30V, -40-85°C, M8 Male (connector) 4pin, IP67, Brass

AO000067



accessories optical, Mounting angle bracket, 34x20x26mm, Angle, Steel, 90°

VY000004



DC power supply, sensor tester, 120x26x72mm, 18V, 0.04A, Spring clamp connection 4pin, IP20, Plastic

You can find further accessories on our homepage



Installation

Mounting / installation may only be carried out by a qualified electrician!



Disposal

WEEE number according to § 6 para. 3 ElektroG: 40951076

Safety warnings

/ Before initial operation, please make sure to follow all safety instructions that may be provided in the product information.

/ Never use these devices in applications where the safety of a person depends on their functionality.