

IN32E332-S

Inductive sensors • Increased ambient temperature

Sensor inductive, M32x1.5 83.5long, non-flush, Sn: 13, 0-230°C, connection to amplifier, lemo connector, IP67, stainl. steel



Inductive proximity switches are contact-free sensors. They detect all conductive metals, regardless of whether they move or not. The achievable sensing range of the devices depends on the object material and its dimensions. The vibration-resistant sensors can be approached laterally or frontally. Inductive proximity switches are used for presence detection (e.g. goods carriers), positioning (e.g. dampers), counting (e.g. nuts /bolts), speed detection (e.g. for cog wheels), on conveyor systems (e.g. hose feedings) or distance measurements (e.g. press-in checking) of metallic objects.

Electrical features

Type of electrical connection	Lemo plug connector
Relative hysteresis	20 %
Switching distance	13 mm
Switching frequency	200 Hz
Connection to amplifier	Yes

Mechanical features

Alignment of cable entry	axial
Design	Cylinder, screw-thread
Thread length	45 mm
Thread pitch	1.5 mm
Length	83.5 mm
Mechanical mounting condition for sensor	non-flush
Degree of protection (IP)	IP67
Active area material of sensor	Plastic (Vectra®)
Housing material	Stainless steel 1.4305
Thread dimension	M32
Ambient temperature	0 - 230 °C

Classification

ETIM 8	EC002714 Inductive proximity switch
--------	-------------------------------------

More

IPF Product Group	700 special devices
packaging dimensions	157 x 97 x 58 mm
gross weight	331 g
Customs tariff number	85365019
WEEE number	40951076
Reach-compliant	Yes
RoHS-compliant	Yes

Connection

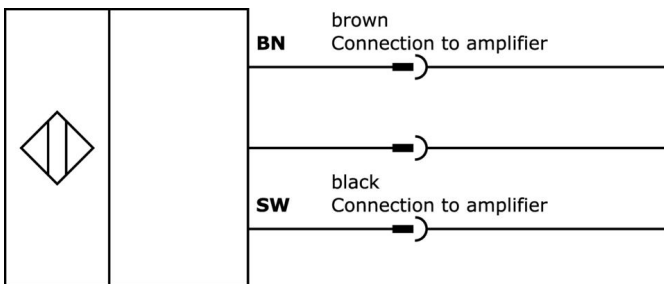

Dimensional drawing

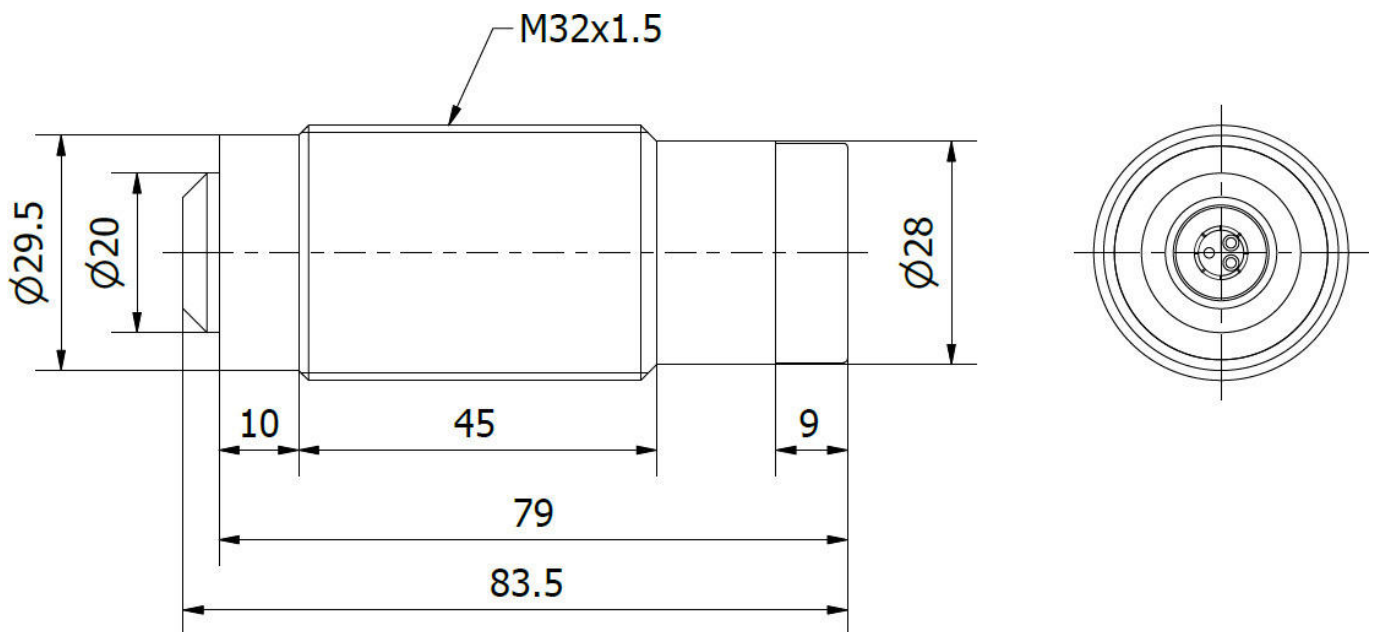

Extract accessories program

VKC0E333-S

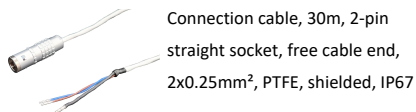

You can find further accessories on our homepage

**Installation**

Mounting / installation may only be carried out by a qualified electrician!

**Disposal**

WEEE number according to § 6 para. 3
ElektroG: 40951076

Safety warnings

- / Before initial operation, please make sure to follow all safety instructions that may be provided in the product information.
- / Never use these devices in applications where the safety of a person depends on their functionality.