

MW110430

Linear and angular measurement • magnetic

linear measurement sensor, magnetic, 37x25x10mm, Relative, Sn: 0.4-2, 24V, Push-pull level, Cable 6pin 2m PUR (Polyurethane), IP67, Plastic, 1.7m/s

including Spring washer



For length measurement, rotational speed or angle measurement, magnetic measuring systems are used. These systems operate in a way that the sensor moves without contact over a flexible magnetic tape, or it is situated above the rotating magnetized measuring wheel. The magnetic tape is applied to a 0.3mm thick steel strip and is located on the circumference of the various measuring wheels. The magnetization is carried out with defined pole pitches. By scanning of the magnetic poles an analog signal is generated, which is converted into digital square wave signals that can be processed by a downstream electronics and, if necessary, be displayed. The sensor detects the pitch of the strip and converts the information into a high-resolution path or rotation information. To read out the magnetic lines no direct contact is required. Magnetic sensors are insensitive to dirt, oils and moisture and relatively stable at shock and vibration. For users, this opens up a wide field of applications, e.g. for plants and systems in the timber industry, at linear axes, in outdoor areas or with machine tools.

Electrical features

Type of electrical connection	Cable
Type of switching output	Push-pull level
Operating principle	Relative
Short-circuit protection	Yes
No-load current	70 mA
Number of pins	6
Pulse interval	4 µs
Signal outputs	A+B (+inverted)
Reverse polarity protection	Yes
Operating voltage (DC)	24 V
Measuring range	0,4 - 2 mm

Mechanical features

Width	10 mm
Height	37 mm
Cable length	2 m
Storage temperature	-30 - 80 °C
Length	25 mm
Max. traverse speed	1.7 m/s
Degree of protection (IP)	IP67
Housing material	Plastic
Material of cable sheath	Plastic (PUR)
Ambient temperature	-10 - 70 °C
Line diameter	5 mm

Other features

Relative air humidity (non-condensing)	0 - 100 %
--	-----------

Classification

ETIM 8	EC001852 Displacement sensor
--------	------------------------------

More

IPF Product Group	235 magnetic linear measurement systems
packaging dimensions	149 x 124 x 28 mm
gross weight	130 g
Customs tariff number	90318020
WEEE number	40951076
Reach-compliant	Yes
RoHS-compliant	Yes

Connection

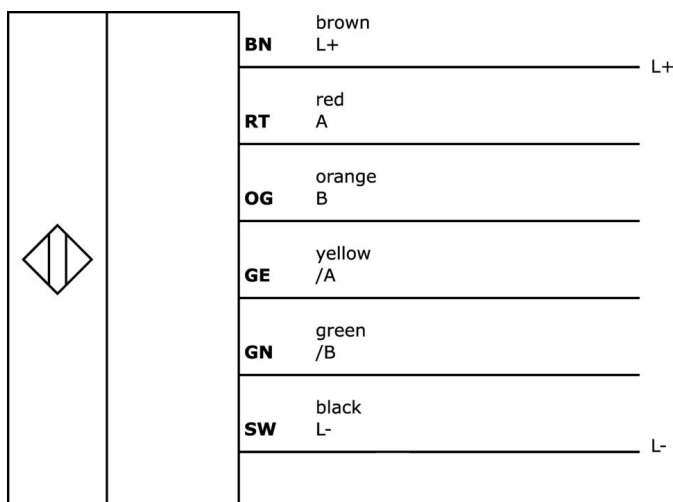

Dimensional drawing

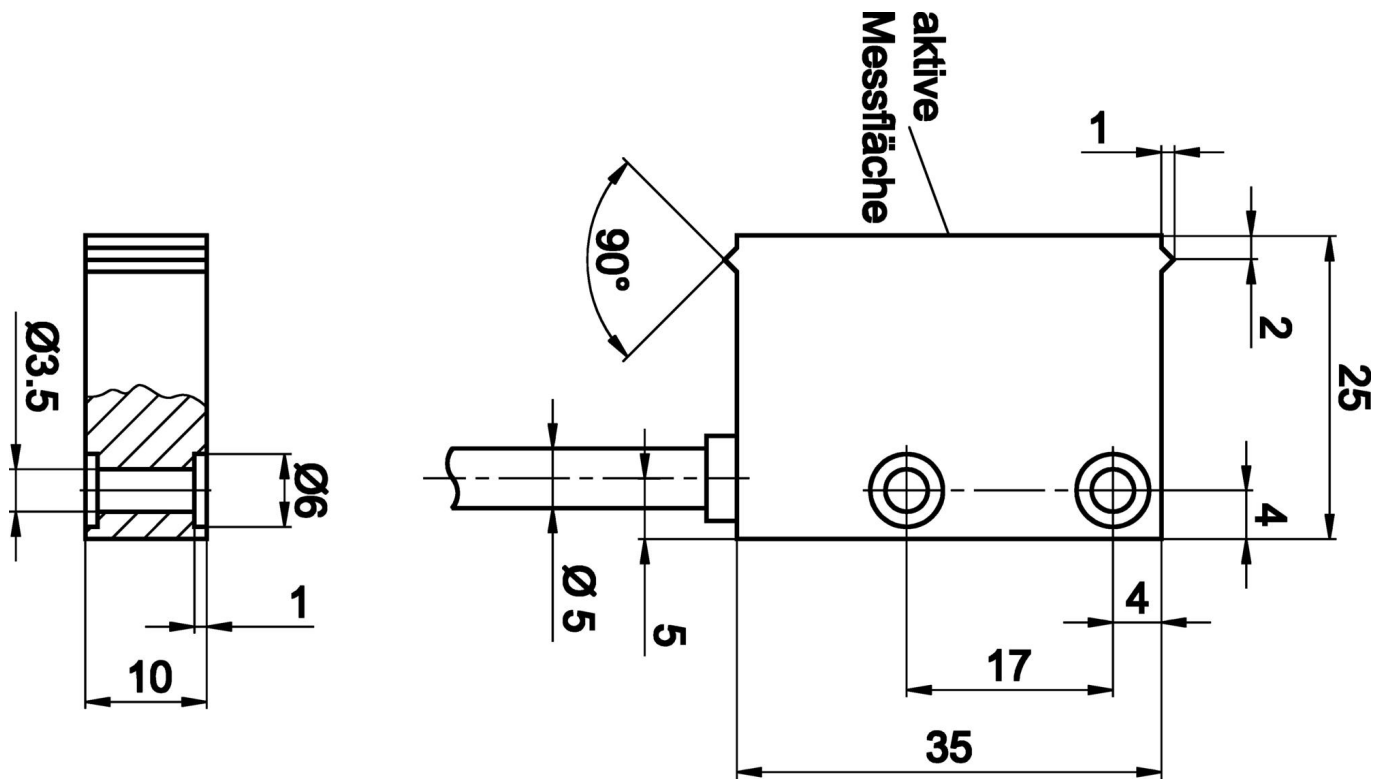

Extract accessories program

AM000059



accessories magnetic, magnetic strip, Width 10mm, pole length 5mm, resolution 0.01mm, Plastic+Stainless steel, yard good

AY000141



Plastic sheath, $\varnothing 17$ mm, Inner diameter 10mm, -40-250°C, Glass fiber with silicone rubber, Short-term resistance to weld spatter 1200°C, Tensile strength 400N, Flexible, Flame retardant, yard good

WY050100



speed monitoring, 48x115x96mm, 24V DC, 4x PNP Programmable/configurable, 0-10V/4-20mA / 0 ... 20 mA, Screw connection, IP65, Noryl UL94, Multifunctional device, With LCD display, One- and two-channel, Parameterization

You can find further accessories on our homepage



Installation

Mounting / installation may only be carried out by a qualified electrician!



Disposal

WEEE number according to § 6 para. 3 ElektroG: 40951076

Safety warnings

/ Before initial operation, please make sure to follow all safety instructions that may be provided in the product information.

/ Never use these devices in applications where the safety of a person depends on their functionality.