

OGKG0572

Optical sensors • Forked light barriers

sensor optical, fork, 194x12x140mm, fork width 170mm, 10-30V DC, 1x PNP/NPN NC/NO, IO-Link, Connector M8 3pin, IP67, Zinc die-cast+Glass, Red light, 5kHz pulsed, Manual adjustment



Special design of through-beam sensor. Transmitter and receiver are located in the fork or angular limbs and are perfectly aligned to each other.

Electrical features

Response/decay time	0.1 ms
Number of switching outputs	1
Resolution	0.5 mm
Type of the forked light barrier	Standard
Type of switching function	Normally closed contact/normally open contact
Type of electrical connection	Connector M8
Type of switching output	PNP/NPN
Rated switching current	100 mA
Setting procedure	Potentiometer
Short-circuit protection	Yes
No-load current	30 mA
Number of pins	3
Repeatability +/-	30 µm
Switching frequency	5000 Hz
Protection class	III
Scanning function	Light-/dark-on mode
Reverse polarity protection	Yes
Decay time	0.1 ms
Absolute repeat accuracy	0.03 mm
Supported communication interface	IO-Link
Operating voltage (DC)	10 - 30 V
Output functions	Switching point

Mechanical features

Design	Cuboid
Fork light barrier design	Furcate
Width	140 mm
Fork depth	110 mm
Fork width	170 mm
Height	194 mm
Length	12 mm
Degree of protection (IP)	IP67
Active area material of sensor	glass
Housing material	Zinc die-cast
Ambient temperature	-25 - 60 °C

Optical features

Light source	red light
Light beam form	Point
Min. object size	0.5 mm
Wavelength of the sensor	660 nm
Pulsed light source	Yes

Other features

IO-Link version	V1.1
Feeding technology	Yes

Classification

ETIM 8	EC002720 Fork light barrier
--------	-----------------------------

More

IPF Product Group	110 fork / angular light barriers
packaging dimensions	315 x 190 x 35 mm
gross weight	488 g
Customs tariff number	85365019
WEEE number	40951076
Reach-compliant	Yes
RoHS-compliant	Yes

Connection

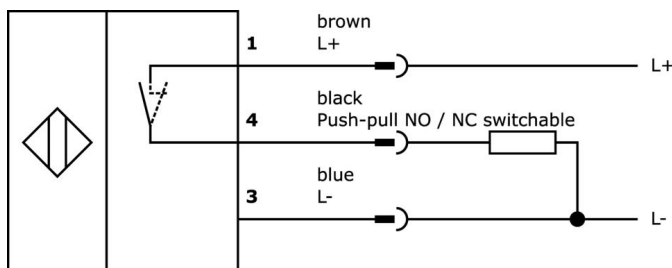

Dimensional drawing

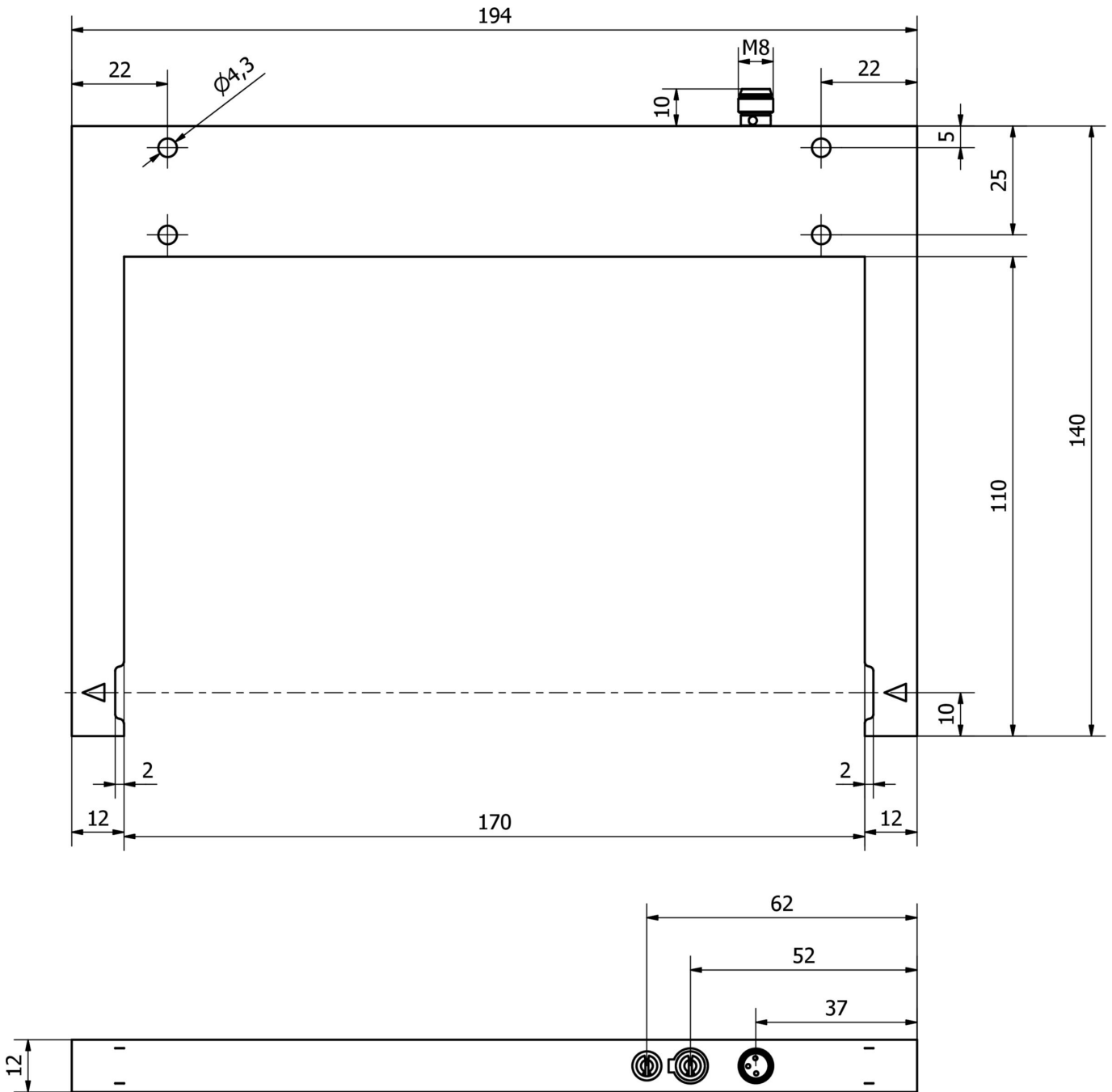

Extract accessories program

VL300138



Logic module, 26x136x30mm, OR, 2x4fold, 10-30V DC, sensor side M8 Female (socket) 3pin, control side M12 Male (connector) 12pin, IP67, Plastic

VL300148



Logic module, 26x136x30mm, AND, 4fold, 10-30V DC, sensor side M8 Female (socket) 3pin, control side M12 Male (connector) 12pin, IP67, Plastic, Signal change logic

AO000095



accessories optical, Cleaning air nozzle, Metal

AO000100



accessories optical, Cleaning air nozzle, 60mm long, Metal

VY000005



IO-Link master, 41x24x67mm, IO-Link, M12, With USB interface

VY030170



time stage, Turn-off delay, 0-0.15s, 10-35V DC, 1x NO, M8 3pin 0.3m, IP67, Plastic, Potentiometer

VY030174



time stage, Turn-off delay, 0-0.15s, 10-35V DC, 1x NO, M8 3pin 0.3m, IP67, Plastic, Potentiometer

VK000038



Adaption, M8 Female (socket) 3pin Straight, M8 Male (connector) 4pin Straight, 24V, -25-85°C, IP67, Oil and cooling lubricants, Welding area

AY98C293



accessories sensor, Teflon cap, M8x1 5long, Polytetrafluorethylene (PTFE)

You can find further accessories on our homepage



Installation

Mounting / installation may only be carried out by a qualified electrician!



Disposal

WEEE number according to § 6 para. 3 ElektroG: 40951076

Safety warnings

/ Before initial operation, please make sure to follow all safety instructions that may be provided in the product information.

/ Never use these devices in applications where the safety of a person depends on their functionality.

/ Any software, drivers or IODD files that may be required to operate your device can be downloaded free of charge from our homepage: www.ipf-electronic.com