

PS500046

Laser sensors • Line sensors transmitters

Sensor laser, line sensor transmitter, 105x30x125mm, aperture 48, Sn: 2m, 22-26V DC, plug connector M9 4-pin, IP54, aluminum anodized/anodized, laser diode, red light



Optical sensors function contactlessly. They detect objects independent of their characteristics (e.g., shape, color, surface structure, material). The basic operating principle is based on the transmission and reception of light. There are three different versions: 1. The through-beam sensor consists of two separate devices, a transmitter and a receiver that are aligned with one another. If the light beam between the two devices is interrupted, the switching output integrated in the receiver changes its status. 2. With the retro-reflective sensor, the transmitter and receiver are located in one device. The emitted light beam is reflected back to the receiver by a reflector that is to be mounted opposite the device. As soon as the light beam is interrupted, the switching output integrated in the device changes its status. 3. With the diffuse reflection sensor, the transmitter and receiver are in one device. The emitted light beam is reflected by the object that is to be detected. As soon as the receiver detects the reflected light, the switching output integrated in the device changes its status.

Electrical features

Type of communication interface, transmitter + receiver	Connector M9
Type of electrical connection	Connector M9
Setting procedure	Parameterization Teach-In
Laser power	0.4 mW
No-load current	200 mA
Number of pins	4
Number of pins of communication interface, transmitter + receiver	4
Switching distance	0 - 2000 mm
Type of plug-in contact, communication interface	Female (socket)
Operating voltage (DC)	21,6 - 26,4 V

Mechanical features

Design	Cuboid
Width	125 mm
Field height	48 mm
Height	105 mm
Storage temperature	-20 - 85 °C
Length	30 mm
Surface	teflon coated
Degree of protection (IP)	IP54
Housing material	Aluminum
Ambient temperature	-10 - 50 °C

Optical features

Aperture length	48 mm
Filter	Interference filter
Laser class	Class 1
Light source	Laser diode, red light
Light beam form	Line
Wavelength of the sensor	670 nm

Classification

ETIM 8	EC002716 Through-beam photoelectric sensor
--------	--

More

IPF Product Group	165 laser line sensors
packaging dimensions	210 x 138 x 95 mm
gross weight	409 g
Customs tariff number	85365019
WEEE number	40951076
POP-compliant	Yes
Reach-compliant	Yes
RoHS-compliant	Yes

Connection

Transmitter-receiver connection

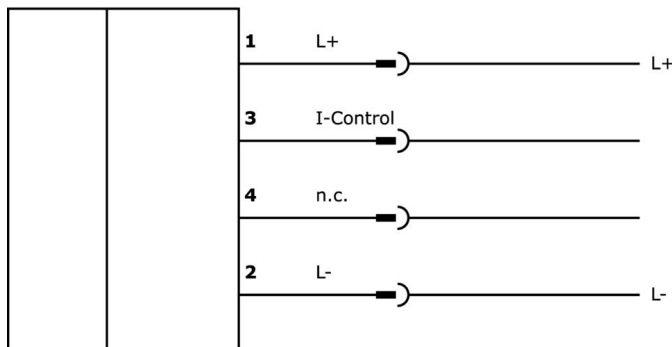

Dimensional drawing

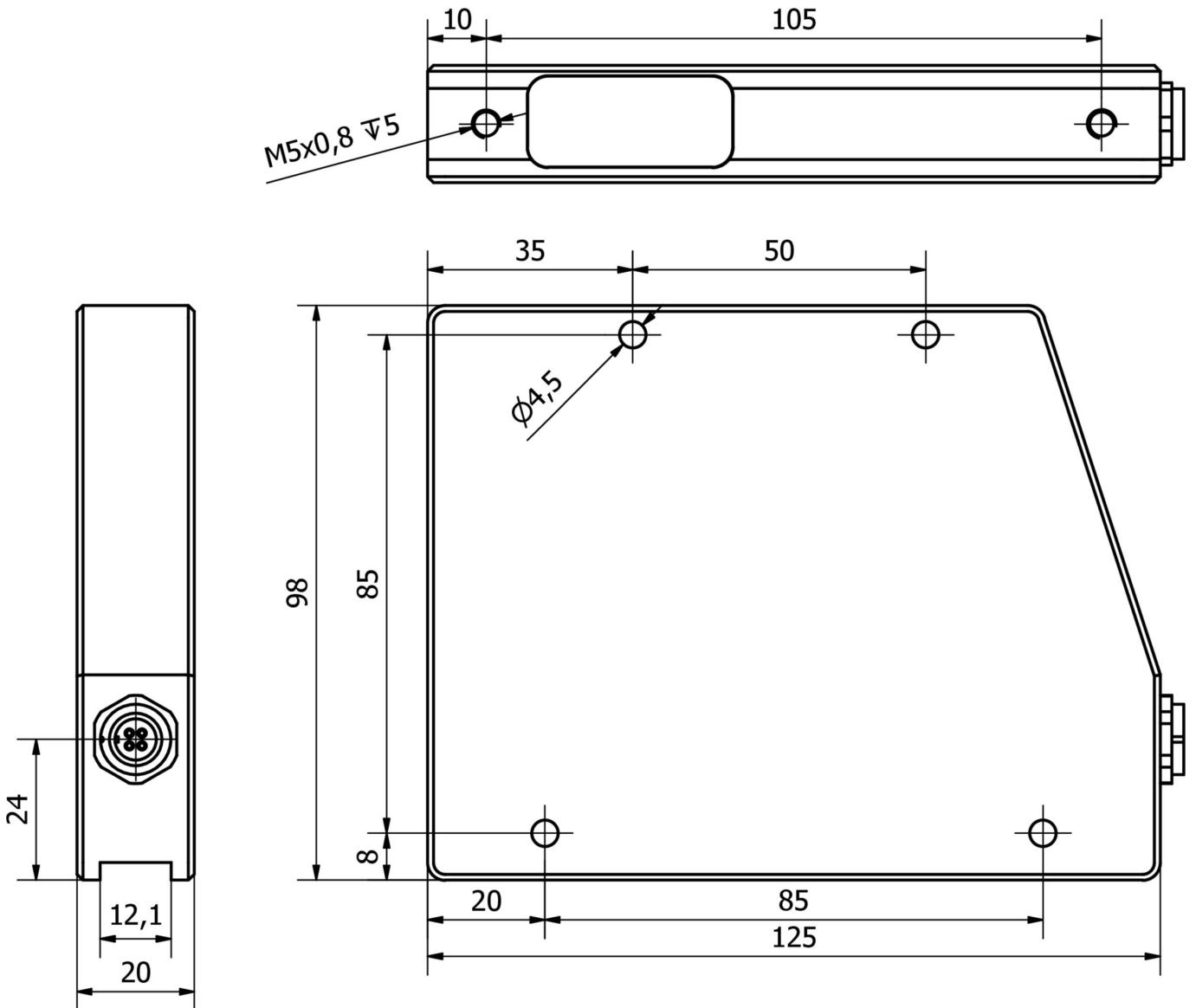

Extract accessories program**PE500146**

sensor laser, Line sensor receiver,
20x75x98mm, Sn: 2m, 22-26V DC,
PNP/NPN Push-pull, 0-10V/4-
20mA, Connector M9 8pin, IP54,
Aluminum Anodised, Laser diode,
red light

VK107F46

Connection cable, 1m, M9
connector 4-pin straight, M9
connector 4-pin straight, 4-core,
PUR (polyurethane)

VK207F46

Connection cable, 2m, M9
connector 4-pin straight, M9
connector 4-pin straight, 4-core,
PUR (polyurethane)

AP000032

accessories laser, Cross-arm,
20x21x400mm, Aluminum

AP000033

accessories laser, Cross-arm,
20x21x600mm, Aluminum

You can find further accessories on our homepage

**Installation**

Mounting / installation may only be carried
out by a qualified electrician!

**Disposal**

WEEE number according to § 6 para. 3
ElektroG: 40951076

Safety warnings

/ Before initial operation, please make sure to follow all safety instructions that may be provided in the product information.

/ Never use these devices in applications where the safety of a person depends on their functionality.