

# YM990415

## Mechanical sensors • Precision switches

Single position switch, Inductive, M8x0.5 28long, 5-36V DC, PNP NO, Cable 0.8m, IP50, Brass Nickel-plated

including Nut

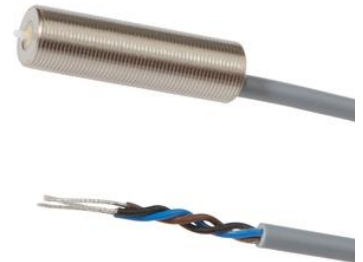

### Electrical features

Number of operating cycles	1000000
Number of normally open contacts	1
Type of switching function	Normally open contact (NO)
Type of control element	Spring-rod
Type of electrical connection	Cable
Type of switching output	PNP
Rated switching current	50 mA
Accuracy	0.001 mm
Switching frequency	10 Hz
Absolute repeat accuracy	0 mm
Measurement principle	Inductive
Operating voltage (DC)	5 - 36 V

### Mechanical features

Alignment of the control element	axial
Design	Cylinder, screw-thread
Thread pitch	0.5 mm
Cable length	0.8 m
Length	28.5 mm
Maximum tightening torque	3.5 Nm
Surface	nickel-plated
Degree of protection (IP)	IP50
Housing material	Brass
Thread dimension	M8
Ambient temperature	-20 - 75 °C
Line diameter	4 mm

### Classification

ETIM 8	EC000030 Single position switch
--------	---------------------------------

**More**

IPF Product Group	690 diverse sensors
packaging dimensions	123 x 77 x 25 mm
gross weight	40 g
Customs tariff number	85365019
WEEE number	40951076
OzDS-compliant	Yes
POP-compliant	Yes
Reach-compliant	Yes
RoHS-compliant	Yes

**Connection**

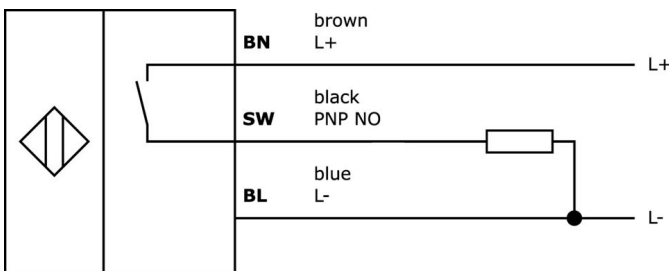

**Dimensional drawing**

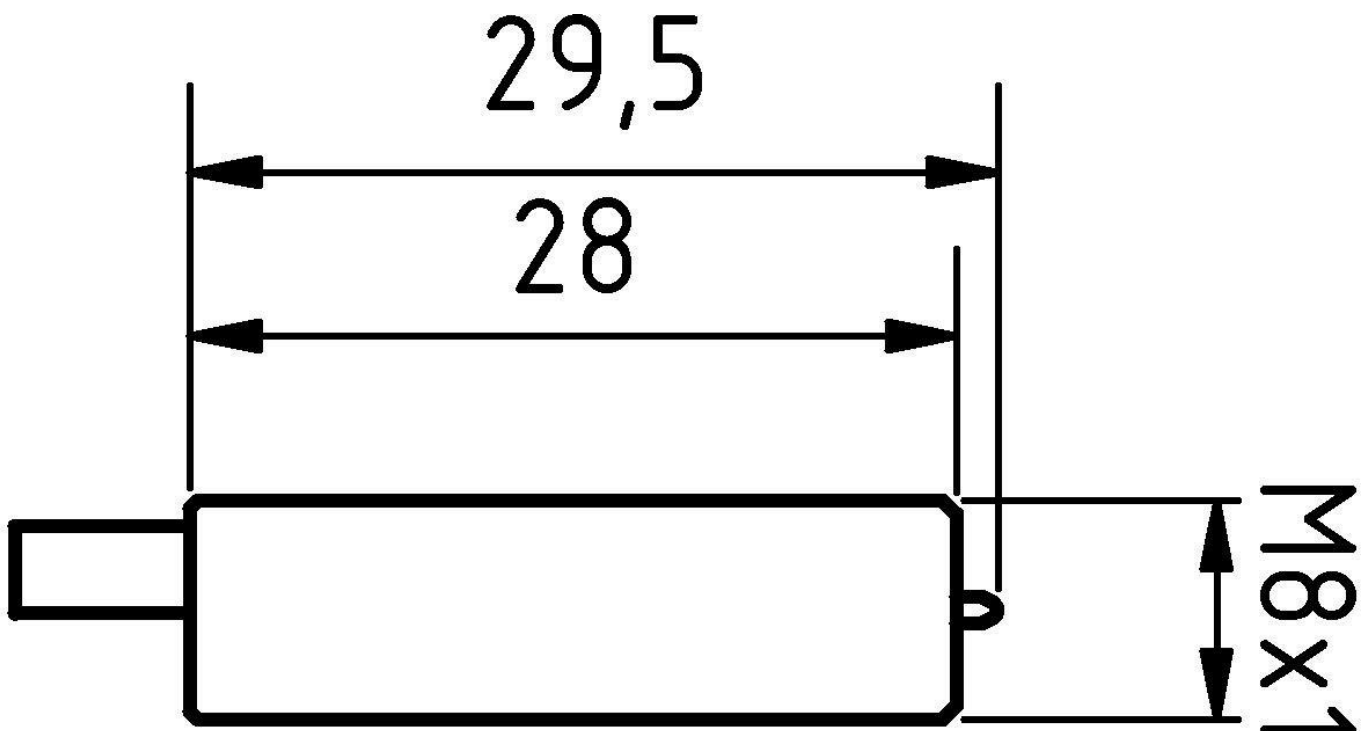

---

**Extract accessories program****AY000141**

Plastic sheath, Ø17mm, Inner diameter 10mm, -40-250°C, Glass fiber with silicone rubber, Short-term resistance to weld spatter 1200°C, Tensile strength 400N, Flexible, Flame retardant, yard good

You can find further accessories on our homepage

**Installation**

Mounting / installation may only be carried out by a qualified electrician!

**Disposal**

WEEE number according to § 6 para. 3  
ElektroG: 40951076

---

**Safety warnings**

- / Before initial operation, please make sure to follow all safety instructions that may be provided in the product information.
- / Never use these devices in applications where the safety of a person depends on their functionality.